

NicePark System

The new automatic management system for off-street car-parks. Versatile, flexible and complete. Born fully grown!

Catalogue

2012



Nice

Home Automation

WITICE

PARK

SYSTEM



NicePark System

Welcome to the NicePark 04|11

Access terminals 12|16

Payment terminals 17|19

Software 20|23

Accessories 24|25

Road barriers 26|37

Configurations 38|51

Connections 52|53

Compatibility 52

From today, the Nice world includes a Car Park System.

Born fully grown!

Designed to manage the varying requirements needed today for the professional management of: urban car parks, the entrances to exhibition centres, retail malls, hospitals, amusement parks, airports and stations, and every kind of community, whether small, medium or large.

Complete

The system offers access control, user identification, and integration with payment systems with automatic or manual payment points.

Versatile

Versatile, flexible customisation, thanks to the system's components, designed to be modular and scalable to suit all requirements.

Innovative

State-of-the-art software: really easy to install, use and program. It allows safe, user-friendly, quick operation.

“

User-friendly, stylish, safe.
Integrated solutions
for the professional.
Nice opens out new
horizons to make life easier.

”



Welcome
to the
Nice
Park

P

ENTER ↔

Nice Total Control

Integrated solutions for the home.

User-friendly, stylish, safe.

Nice products are popular with customers because they are easy to install and use, thanks to a product range that combines innovation and style:

1. **technology for the installer**
2. **convenience for the user**
3. **simplicity for everyone**

With Nice, not only gates, garage doors, awnings and roller shutters but also lighting, alarm and now car park systems are always under control.



For alarm systems



For blinds and rolling shutters



For venetian blinds





For industrial doors



For gates



For garage doors



For road barrier systems



For parking systems



For lighting systems



A Complete System

Turnkey off-street car-park management solutions.



The NicePark System terminals

Transit terminals ideal for managing car parks, access control systems, information totems and guided routes.

NicePark Cash and NicePark Automatic Cash: manned and automatic payment points for all payment systems, for both occasional customers and ticket holders for every type of pay-to-use car park, including multi-storey facilities.

The software plug and play solutions, also allowing remote control

Designed for the utmost scalability. From the standard car park management module (customer record storage, customer account recording and network distribution of data), to functions which can be added over time, for: access control, guided routes, information and advertising totems, including models with time scheduling, to equipment for remote supervision of the installation.



So many extra functions!
640x480 screen for advertising and customisation messages, with modular options which are scalable over time.

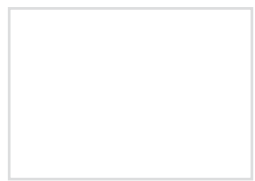

For completing and customising every system

System management information screens; two-light (red/green) LED access control traffic light; intercom system for communications between the various access terminals and the operator station, from the conventional to state-of-the-art VoIP.

The barrier specifically designed for parking systems

Nice range of barrier: the ideal solution for controlling vehicle transit in waiting and parking areas and on private and condominium access roads, even with heavy traffic.

The control accessories

Nice Opera, the innovative system for managing, programming and controlling automation systems, even from remote, simply and safely, with impressive time savings.

A close-up photograph of a NicePark System Terminal. The terminal is a white, cylindrical device with a red stripe running diagonally across its side. It is mounted on an orange-colored metal structure. The terminal has several small holes on its side and a larger circular opening at the bottom. The background is a solid grey color.

**NicePark
System
Terminals**



Convenient

Convenient door that simplifies maintenance and consumables top-up procedures. Security lock.



Safe

Integral flashing light, with excellent visibility guaranteed. Hours of darkness light function for on-site lighting. Built in tough aluminium to withstand vandals.



Intelligent

Arrangement for the mounting of photocells inside the internal custom-assembled compartments.



State-of-the-art

State-of-the-art car-park management thanks to integral software and user-friendly colour display, customisable with modular options scalable over time.



User-friendly compact design

Rapid, easy access to internal components. The separate enclosures for electronics and mechanics protect internal parts from potential hazards. Stainless steel case with cataphoresis painted finish. The innovative Combi Terminal version combines the convenience of the terminal with the power and speed of Nice barrier arms in a combined solution that cuts costs, including for installation.



Nice Standard Terminal



Standard Terminal, the Nice system for performing conventional vehicle access management system functions.

Ideal for use in car-parks, the vehicle access control systems of companies and organisations of various kinds, exhibition centre entrances, camp-sites, camper van parks, sports facilities, information totems, pedestrian and vehicle guided routes and more besides.

In the basic version, the terminal **is equipped with an information display for messages for users, internal temperature control system, embedded PC.**

The large side door provides easy access for both installation and maintenance, and if occasional users have to be managed, loading with “consumables” is very quick and easy.

The optional high-efficiency LED indicator can be integrated in the lid of the steel structure and can just provide lighting for the location. If needed, it can serve also as an access-way traffic light, saving installation time and hardware costs.

The basic system is equipped for the installation of conventional intercom and VoIP systems.

A series of hardware and software options are available for user identification, the management of advertising, integration with supervision systems, exhibition management systems, ...

Code	Description
PRKTSB	Basic Standard Terminal. Vehicle access control system for installation in both entrance and exit terminal configurations
PRKTSB001	Basic Standard Terminal (PRKTSB). Complete with: - PRKATXRFIDRO Basic hardware module for user recognition by means of Read Only RFID technology, 125 kHz - PRKATXPRN Basic hardware model for issuing barcode tickets to users by means of thermal printer - PRKATXMA2 Front panel for installation of additional printer module on basic terminals
PRKTSB002	Basic Standard Terminal (PRKTSB). Complete with: - PRKATXRFIDRO Basic hardware module for user recognition by means of Read Only RFID technology, 125 kHz - PRKATXIMG Basic hardware module for user recognition by means of barcode reader - PRKATXMA3 Front panel for installation of additional optical reader module on basic terminals

* For purchase only in combination with the “Hardware identification options” and “Metal structural options”. See page 25.

Technical specifications

Code	PRKTSB
Electrical data	
Power supply (Vac 50/60 Hz)	220 V
Absorption (A)	1.5
Power (W)	500
Dimensional and general data	
Protection level (IP)	43
Working temp. (°C Min/Max)	-20 ÷ +50
Dimensions (mm)	400x300x1450 h
Weight (kg)	40

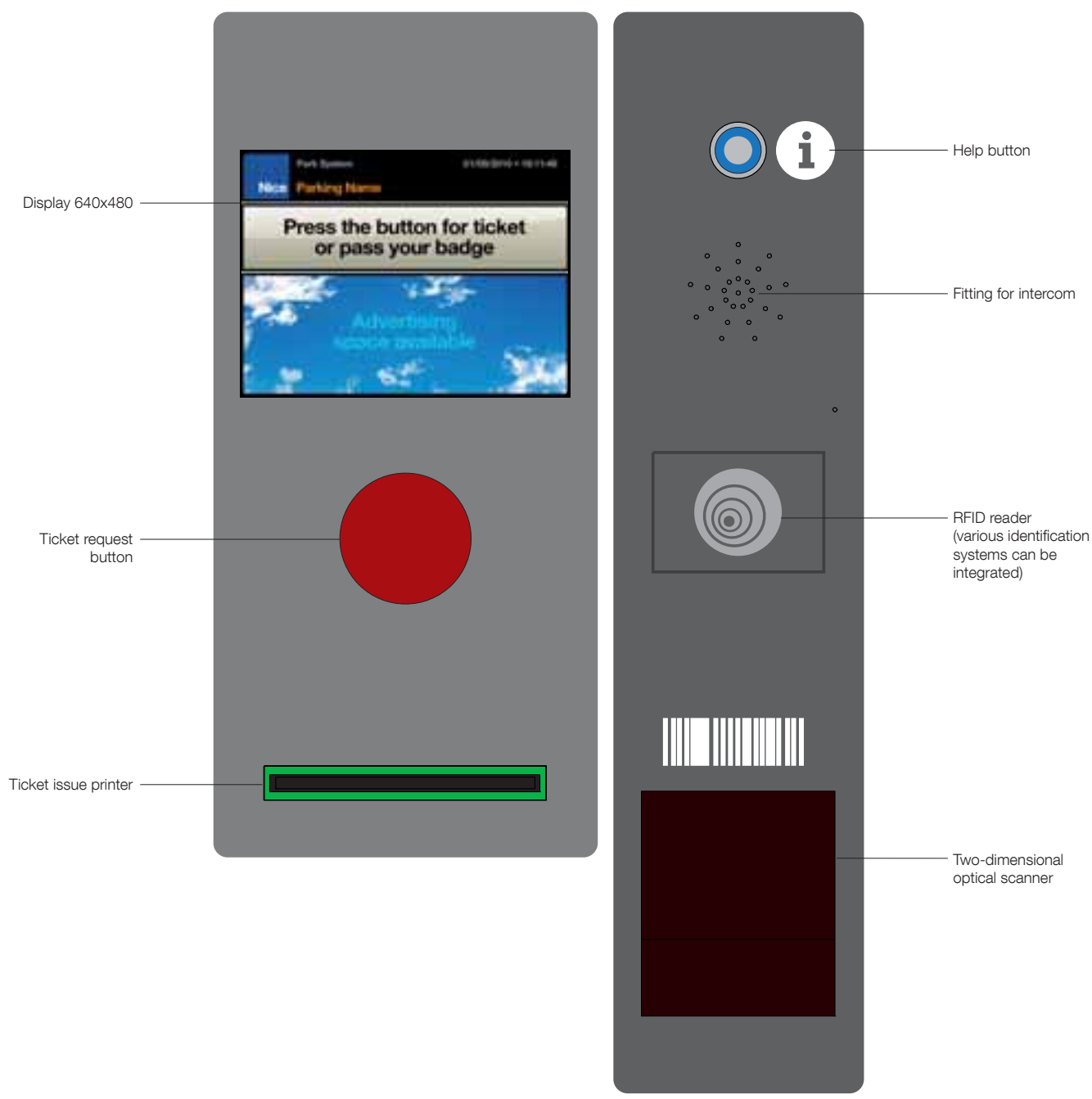

More info

Display

High-luminosity LCD 640x480, 5.7".

Central control station interfaces:

- The system is equipped with:
- 3 RS232 interfaces (one of which is 1 RS485)
 - 1 LVDS video interface
 - 1 mouse and keyboard input
 - 2 USB ports
 - 1 RJ45 network connector 10/100 Mbit
 - 1 audio input for microphone and 1 loudspeaker output.
 - 4 entrance control units
 - 4 exit control units
 - 1 T4 Bus interface

User Management

- occasional users with charging per hour, by entrances/exits, on all-inclusive charge basis.
- ticket-holders of all types: for set time periods (monthly, weekly, daily)... prepaid by time, by value and by entrances/exits.

Data storage

Local relational database replicated on central server and on remote backup server, if installed.

Operating modes

Able to operate in three different modes:

- completely stand-alone (Local-Only)
- only connected to management Server (Remote-Only)
- automatic (Mixed Mode) with connection to server: with lower-level operation still provided if connection fails.

Hardware Prefittings

- Equipped to manage:
- RFID 125 kHz
 - Mifare R&W RFID
 - number plate reading systems
 - 1D barcode
 - 2D barcode
 - etc.

Software capabilities

- Equipped to manage:
- advertising systems
 - VoIP management for service to car-park customers
 - local and remote supervision systems
 - etc.

Nice Combi Terminal



Combi Terminal, the most intelligent solution: installation times and number of fixing points halved. As well as all the functions in the standard terminal, this model also incorporates the Nice road barrier system functions to minimise installation and maintenance times.

The ideal solution for installations where the entrance and exit points of the area for control are alongside each other; in this situation, all this product's capabilities are used to the full, delivering complete management of the car-park's entrance and exit points with just two terminals with integral road barrier system.

In the basic version, the terminal **is equipped with an information display for messages for users, internal temperature control system, embedded PC.**

The large side door provides easy access for both installation and maintenance, and if occasional users have to be managed, loading with "consumables" is very quick and easy.

The basic system is equipped for the installation of conventional intercom and VoIP systems.

A series of hardware and software options are available for user identification, the management of advertising, integration with supervision systems, exhibition management systems, ...

The optional high-efficiency LED indicator can be integrated in the lid of the steel structure and can just provide lighting for the location. If needed, it can serve also as an access-way traffic light, saving installation time and hardware costs.

Ideal for use in car-parks, the vehicle access control systems of companies and organisations of various kinds, exhibition centre entrances, camp-sites, camper van parks, sports facilities, information totems, pedestrian and vehicle guided routes and more besides.

Code	Description
PRKTCB*	Basic Combi Terminal. Vehicle access control system integrated with Nice road barrier system, ideal for installation in both input and output terminal configurations where access points are alongside each other
PRKTCB001	Basic Combi Terminal (PRKTCB). Complete with: - PRKATXRFIDRO Basic hardware module for user recognition by means of Read Only RFID technology, 125 kHz - PRKATXPRN Basic hardware model for issuing barcode tickets to users by means of thermal printer - PRKATXMA2 Front panel for installation of additional printer module on basic terminals
PRKTCB002	Basic Combi Terminal (PRKTCB). Complete with: - PRKATXRFIDRO Basic hardware module for user recognition by means of Read Only RFID technology, 125 kHz - PRKATXIMG Basic hardware module for user recognition by means of barcode reader - PRKATXMA3 Front panel for installation of additional optical reader module on basic terminals

* For purchase only in combination with the "Hardware identification options" and "Metal structural options". See page 25.

Technical specifications

Code	PRKTCB
Electrical data	
Power supply (Vac 50/60 Hz)	220 V
Absorption (A)	2,8
Power (W)	650
Dimensional and general data	
Protection level (IP)	43
Working temp. (°C Min/Max)	-20 ÷ +50
Dimensions (mm)	400x300x1450 h
Bar Length (m)	3
Weight (kg)	40
Performance data	
Opening time (s)	1,5 - 4
Torque (Nm)	100
Work cycle (cycles/hour)	500

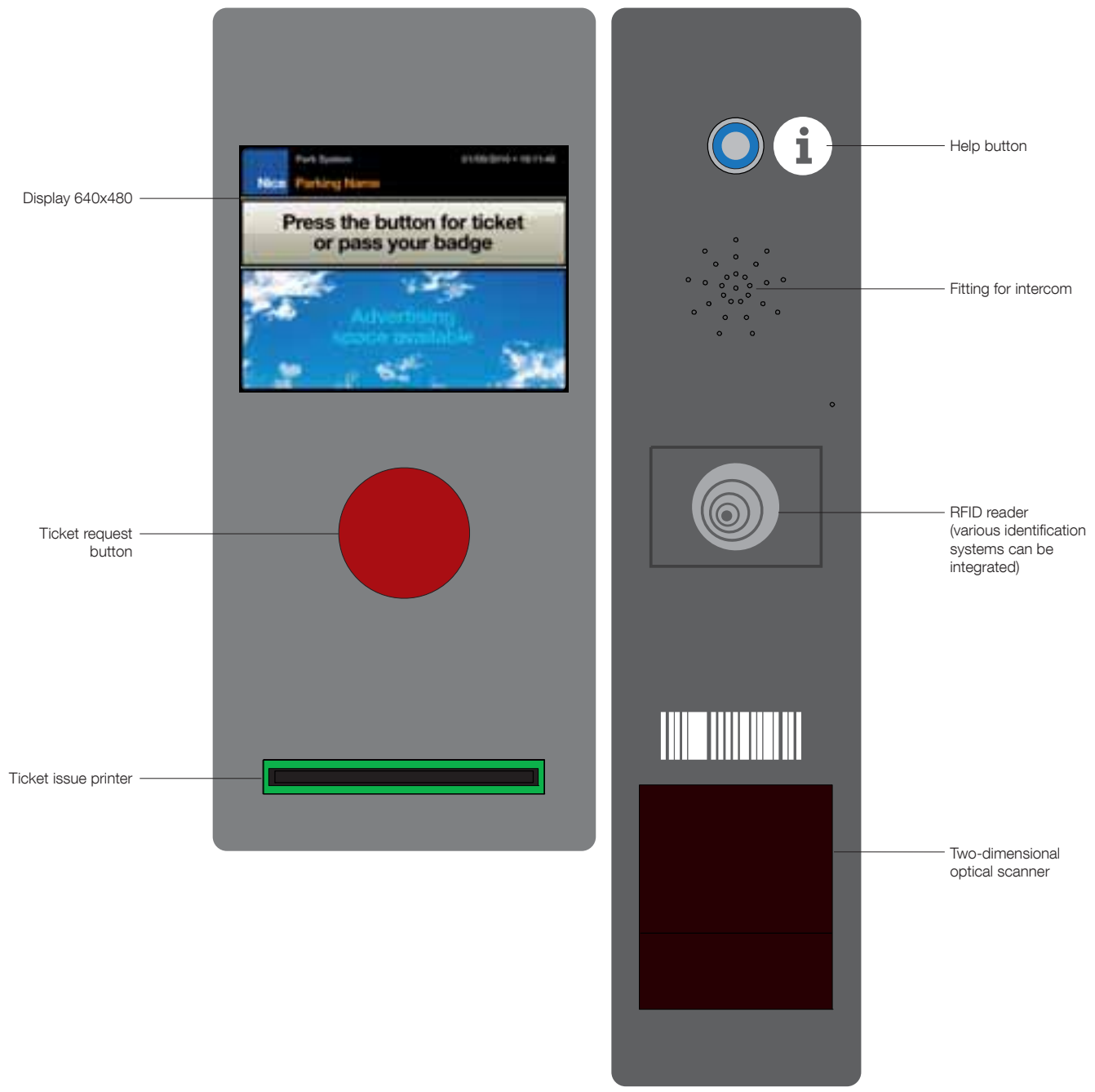

More info

Display

High-luminosity LCD 640x480, 5.7".

Central control station interfaces:

The system is equipped with:

- 3 RS232 interfaces (one of which is 1 RS485)
- 1 LVDS video interface
- 1 mouse and keyboard input
- 2 USB ports
- 1 RJ45 network connector 10/100 Mbit
- 1 audio input for microphone and 1 loudspeaker output.
- 4 entrance control units
- 4 exit control units
- 1 T4 Bus interface

User Management

- occasional users with charging per hour, by entrances/exits, on all-inclusive charge basis.
- ticket-holders of all types: for set time periods (monthly, weekly, daily)... prepaid by time, by value and by entrances/exits.

Data storage

Local relational database replicated on central server and on remote backup server, if installed.

Operating modes

Able to operate in three different modes:

- completely stand-alone (Local-Only)
- only connected to management Server (Remote-Only)
- automatic (Mixed Mode) with connection to server: with lower-level operation still provided if connection fails.

Hardware Prefittings

Equipped to manage:

- RFID 125 kHz
- Mifare R&W RFID
- number plate reading systems
- 1D barcode
- 2D barcode
- etc.

Software capabilities

Equipped to manage:

- advertising systems
- VoIP management for service to car-park customers
- local and remote supervision systems
- etc.

Nice Number plate recognition system

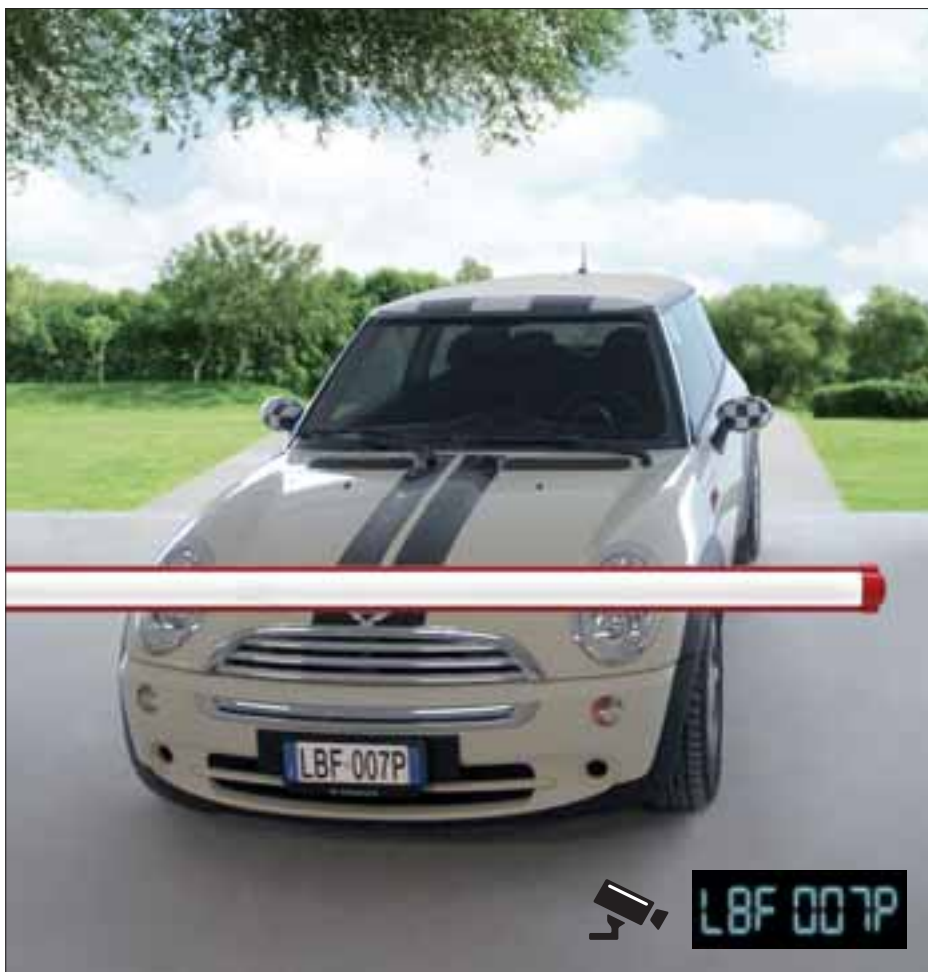

Ideal to manage individual vehicle accesses allowing a better and higher access control.

The Nice number plate recognition system consists of a network camera with on-board OCR.



Code	Description
PRKATXLPR	Number plate recognition module



Complete manned manual payment point system for the management of both occasional users and ticket holders.

A perfect control system!

The Manual Cash Kit is not just an ordinary manual car-park payment point; it is a real car-park control and management system.

So many functions!

For season ticket holder: management of season ticket renewal and expiry is provided, including prepaid charge cards.

For occasional customer: the operator can decide the mode of payment and the type of receipt to be printed. In the event of loss of ticket, the **“lost ticket”** function can be used to print a valid exit ticket for a fixed charge.

Control Function: with the System Monitor software module not only covering payment for use of the car-park but also monitoring of its correct operation.

Code	Description
PRKCMKIT	Manned Manual Payment Point Kit for car-park payment management

Manual Payment Point Kit Composition

Code	Description
PRKCMPC	Server complete with LCD screen and multiple serial port card
PRKACMSW	10/100 Mbit switch (at least 8 ports)
PRKADISP	Single-sided courtesy display for customers
PRKACMPRN	Desktop receipt printer for Manual Payment Point
PRKACMRFIDRO	“RFID Read Only” reader for Manual Payment Point
PRKACMIMG	Basic hardware module for user recognition by means of desktop barcode reader
PRKSWMC	Manual Cash Software
PRKSWCM	Customer Manager Software
PRKSWSM	System Monitor Software
PRKSWDB	Database Server Software

Nice Automatic Cash



The NicePark System is completed by the automatic payment point, ideal for free-standing or wall-mounted installation.

With a tamper-proof structure, it provides basic equipment comprising a control PC, touch screen information display, receipt printer, 125 kHz RFID reader, two-dimensional banknote acceptor and barcode reader and coin acceptor and change unit. All items are thermostatically controlled.

In addition to these standard devices, the system can be equipped with the components necessary for user identification (13.56 MHz RFID reader,...) and any other additional payment systems required such as a credit card reader.

The automatic payment point can be customised with the advertising module which allows the sale of the video space available and the printing of promotional and information tickets (if required) using the receipt printer.

Code	Description
PRKACAB	Automatic Payment Point equipped with coin and banknote acceptor system, Read Only two-dimensional barcode and RFID card reader, LCD information display, and thermostatically controlled tamper-proof structure
PRKACACCR	Credit/debit card reader
PRKACASFF	Ground anchoring system

Technical specifications

Code	PRKACAB
Electrical data	
Power supply (Vac 50/60 Hz)	220 V
Dimensional and general data	
Protection level (IP)	43
Working temp. (°C Min/Max)	-20 ÷ +50
Dimensions (mm)	650x400x1250
Weight (kg)	100

Automatic Cash

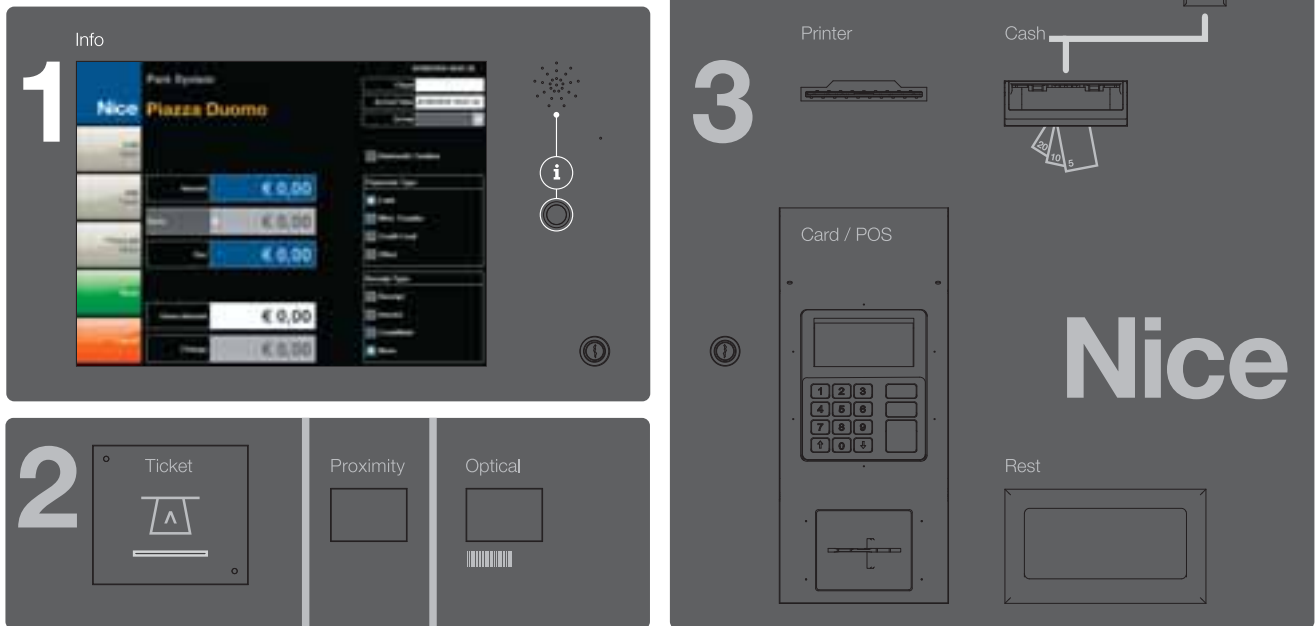

More info

Operating System

LINUX operating system.

Language

Ready for use for:

- Italian,
- English,
- French,
- German,
- Spanish

Provision for any other language with dynamic selection.

Currency

Multiple currency system.
Ready for use for the Euro.
Provision for the US dollar, Sterling,...

Database

Management and logging of all information about users and the transactions performed on the local and/or remote database.

Updates

Software can be updated from remote with no need for an installer on the site.

Logs

Automatic or manual dispatch of logs diversified by categories:

- Accounts (logs relating to cash amounts and customer records; accounting and administrative records...)
- Hardware Maintenance (dispatch of log of alarms and malfunctions...)
- Software Maintenance (dispatch of logs relating to network connections, system backups and restores, software malfunctions in general...).

Security

The automatic identification through the personal badge allows an immediate access to the accounting section.

The heart is the software

Designed for the utmost scalability.

From the standard car park management module (customer record storage, customer account recording and network distribution of data) to functions which can be added over time, for access control, guided routes, information and advertising totems, including models with time scheduling, to equipment for remote supervision of the installation.

State-of-the-art software

designed to be installed even by those with little knowledge of IT systems, configured using graphics in easy drag&drop mode: "the Nice for you Web". Can be installed on Unix/Linux and Microsoft Windows operating systems. Multilingual and multicurrency.

Database Server

Stores season ticket holders' details, user transactions and payments.

Code **PRKSWDB**



Applications Payment Point / Control Station

Customer Manager manages users' details.

Code **PRKSWCM**



Manual Cash manages cash transactions for occasional users and season ticket holders.

Code **PRKSWMC**



System Monitor manages alarms from the various system components (automation opening and closing commands, etc...).

Code **PRKSWSM**



Configurator

Tool for configuring the individual components of the car park system and for creating rules for the management of vehicle flows, price lists and the various operating modes.

- Excellent aid to drawing up quotations and specifications
- User-friendly interface, also has “drag&drop” function
- Configuration of all user enabling, database backup etc. parameters
- Configuration of graphic mimic display for car park supervision.

Code **PRKSWCF**



Allows configuration of one or more price lists for individual groups of users with fixed, proportional or hybrid tariff rates.

Supervisor

Mimic panel for management of car park systems, and access control systems in general.

- Also allows management of more than one system
- Can also be equipped with client VoIP for communication with the various access terminals and automatic and manual payment points
- Screen self-adapts to suit the size of any display.

Code **PRKSWSV**



Local and/or remote management of the same system, even simultaneously.

Advertising Editor

Graphic mimic display for creation of the advertising schedules for the various terminals and the car park payment points.

- Allows loading and elaboration of images
- Allows schedules to be created on a time basis, by number of requests, for user groups ...
- Schedules can be exported for dispatch to the individual car park system.

Code **PRKSWAE**



Shared advertising schedules can be created for access point terminals and automatic and manual payment points.



Basic level plant configuration mode allowing generation of the list of materials needed for realisation of the car park.



Advanced level plant configuration mode allowing full exploitation of all NicePark System features.



Graphic and text modes for clearer display of any malfunctions and/or intuitive use of the system's countless functional features.



Can also be used in "expanded graphic" mode, even more user-friendly when controlling particularly complex systems.



Management of advertising schedules on time basis, by events or in groups, with differentiation for each individual terminal or payment point within the system.



Specific display resolutions can be set to allow management of any advertising screens in the car park, independently of the access point terminals or payment points.

Nice Accessories for completing every system

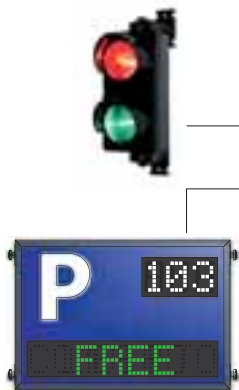

Code	Description
------	-------------

Accessories

For Standard Terminal / Combi Terminal

PRKAXXTLL	LED traffic light
PRKAXXBP	Information screen with 1 three-figure vacancy counter and full/vacancies sign
PRKAXXBPRK	Numerical programming keyboard for information screen
LP1	Single-channel metal mass detector 24 V power supply
LP2	Two-channel metal mass detector 24 V power supply

For Standard Terminal / Combi Terminal / Automatic Cash

PRKAICM	Two-way outdoor intercom
----------------	--------------------------

Consumables

For Standard Terminal / Combi Terminal / Automatic Cash

PRKAPR	Thermal paper for ticket issuer
MOCARD	Pack of 10 RFID cards 125 KHz
MIFCARD	Pack of 10 MiFare Read & Write RFID cards



Code	Description
------	-------------

Hardware Identification Options

For Standard Terminal / Combi Terminal / Automatic Cash

PRKATXIMG	Basic hardware module for user recognition by means of barcode reader
PRKATXRFIDRO	Basic hardware module for user recognition by means of Read Only RFID technology, 125 KHz
PRKATXRFIDRW	Basic hardware module for user recognition by means of MiFare Read & Write RFID technology, 13.56 Mhz

NB: for purchase only in combination with basic Terminal or Automatic Cash.

For Standard Terminal / Combi Terminal

PRKATXPRN*	Basic hardware model for issuing barcode tickets to users by means of thermal printer
PRKATXLPR	Basic hardware module for user recognition by means of number plate recognition system

* for purchase only in combination with basic Terminal or Automatic Cash.

For Customer Management

PRKACMPRN	Basic hardware model for issuing non-fiscal receipt and/or ticket with barcode by means of desktop thermal printer
PRKACMIMG	Basic hardware module for user recognition by means of desktop barcode reader
PRKACMRIDRO	Basic hardware module for user recognition by means of desktop Read Only RFID technology, 125 KHz
PRKACMRIDRW	Basic hardware module for user recognition by means of desktop MiFare Read & Write RFID technology, 13.56 Mhz

Hardware Options

For Customer Management

PRKADISP	Courtesy display for customers
PRKADRA	Metal cash box with security key
PRKCMPC	Personal Computer complete with operating system licence, LCD screen, keyboard and mouse and serial multiport for connection of field devices

For Automatic Cash

PRKACACCR	Credit/debit card reader
PRKACASFF	Ground anchoring system

Metal Structural Options

For Standard Terminal / Combi Terminal

PRKATXMA1	Front panel for installation of RFID module only on basic terminals
PRKATXMA2	Front panel for installation of additional printer module on basic terminals
PRKATXMA3	Front panel for installation of additional optical reader module on basic terminals
PRKATXMA4	Front panel for installation of additional printer and optical reader module on basic terminals

NB: for purchase only in combination with basic Terminal.

Software Options

For Standard Terminal / Combi Terminal

PRKSWTM	Additional Client Software for management of Access Control Logic
PRKSWCADV	Client Software for management of "Advertising Scheduler"



Safe

Integrable flashing or traffic light. Nightlight function for on-site lighting. Vandal-proof thanks to the tough aluminium case.



Nice Road Barrier

High performing, reliable and durable.
Elegant, streamlined design.
Carefully selected materials.
Greater convenience, safety at all times.



Solemyo System

Solemyo solar power kit for the automation of gates, garage doors and barriers even a long way from electricity supplies, with no need for expensive, unsightly trench digging.



Opera System

For user-friendly, safe control, programming and monitoring of automation systems, with impressive time savings.



BlueBUS

The BlueBUS system allows connection of all system devices using just two wires. Quick installation and easy updating at any time!

Elliptical section bar
with high resistance
to gusts of wind.
Led signal lights.

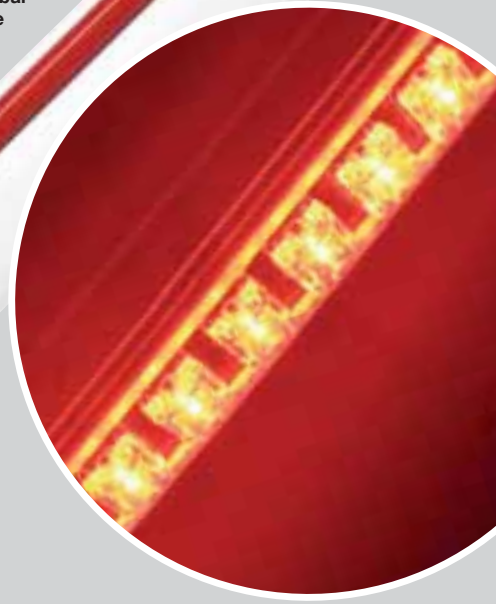

User-friendly compact design

Quick and easy access to internal components with separate enclosures for electronics and mechanics to protect from potential risks. The control unit, located in the upper part of the barrier body, can be reached by simple removing the cover.



Intelligent

Photocells can be fitted in the specially designed seats in the inner part of the barrier body. Integrated loop detector management.



Power and reliability

New high resistance balancing springs guarantee up to 1,000,000 operations. Powerful and fast 24 Vdc gearmotor. Maximum protection: steel housing with protective cataphoresis treatment and paint finish, also available in stainless steel version.



L/M/S Bar Barrier gate operators for all sizes

New range of barrier gate operators to control road access to car parks, private and condominial transit areas, including high traffic ones.

Powerful and fast: 5 models in 3 standard versions, up to 7 modular bars from 3 to 9 m.





SBAR

- **With specific 4 m bar**
Provision for:
protective rubber trim
and indicator lights

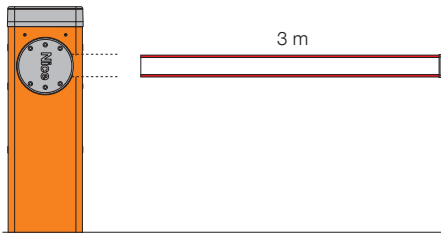

M3BAR

- **With 3 m bar**
Provision for:
protective rubber trim
and indicator lights

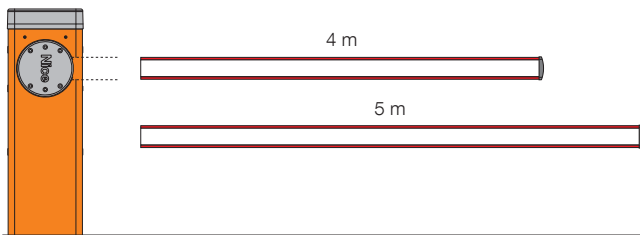

M5BAR

- **With 4 m bar**
Provision for:
protective rubber trim,
indicator lights,
rack, mobile stand
- **With 5 m bar**
Provision for:
protective rubber trim
and indicator lights

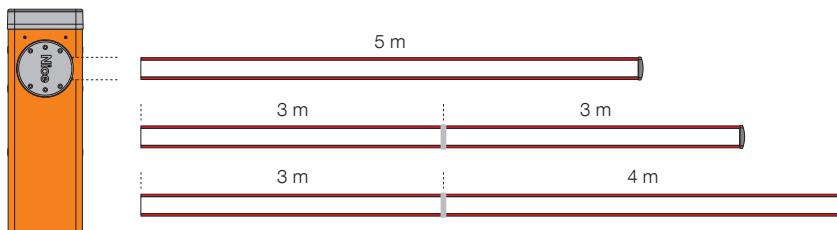

M7BAR

- **With 5 m bar**
Provision for:
protective rubber trim, indicator lights,
rack, mobile stand
 - **With bar up to 6 m (3+3 m)***
Provision for:
protective rubber trim, indicator lights,
rack, mobile stand
 - **With bar up to 7 m (3+4 m)***
Provision for:
protective rubber trim
and indicator lights
- *Use **XBA9** joint to assemble bars

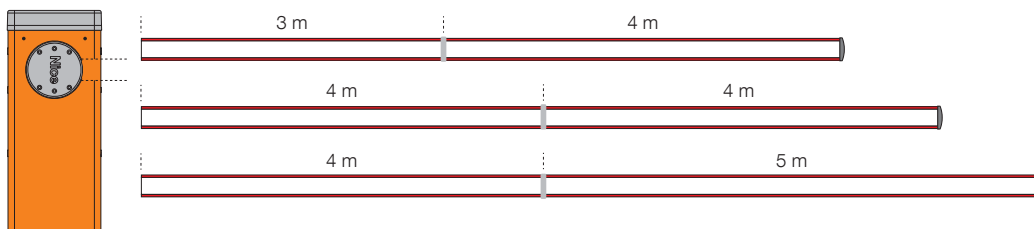

LBAR

- **With bar of 7 m (3+4 m)***
Provision for:
protective rubber trim, indicator lights,
rack, mobile stand
 - **With bar of 8 m (4+4 m)***
Provision for:
protective rubber trim, indicator lights,
rack, mobile stand
 - **With bar of 9 m (4+5 m)***
Provision for:
protective rubber trim
and indicator lights
- *Use **XBA9** joint to assemble bars

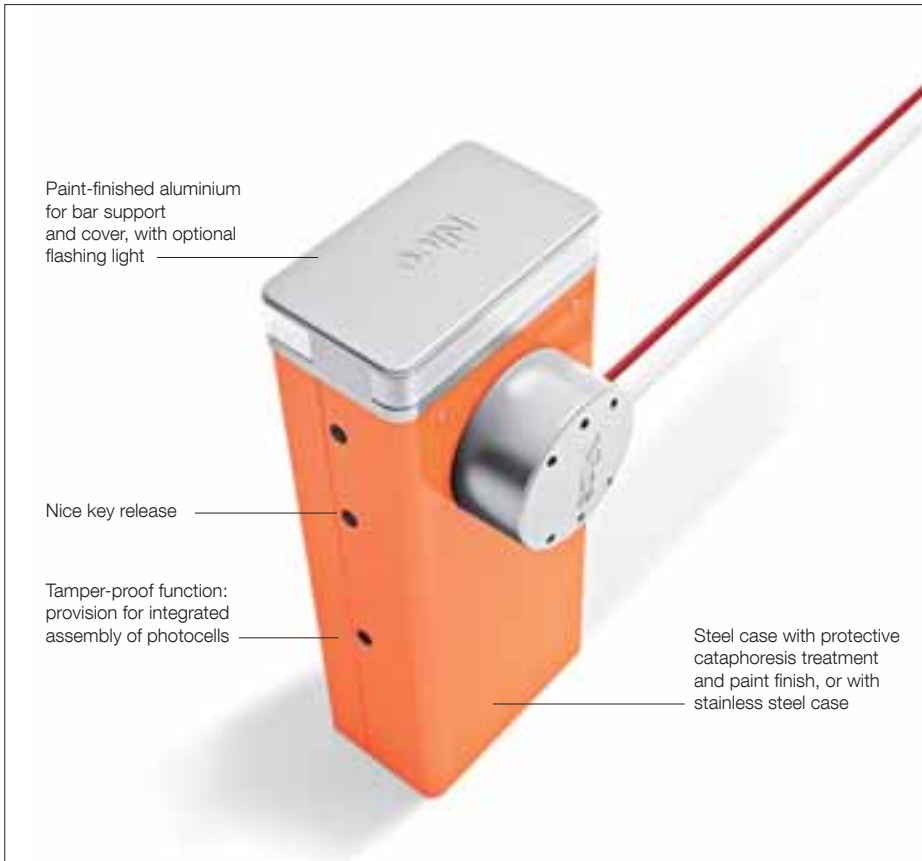

Electromechanical road barrier system for control of road access.
24 Vdc gearmotor with built-in control unit and loop detector.

Powerful and fast, for bars from 7 to 9 m.

Modular: are easily assembled using the aluminium expansion joint.

Possibility for intelligent control of two opposing automations thanks to **“master/slave” function.**

Strength and reliability: robust structure in steel, new high strength balancing springs guaranteed up to 1,000,000 opening and closing operations and elliptical section bar with high wind-gust resistance.

Optional flashing or traffic light can be integrated in cover.

Encoder movement control and electromechanical limit switches.

More comfort and safety in programming and maintenance phases: the separate enclosures for electronics and mechanics protect internal parts from potential risks.

Rapid and easy access to the control unit located in the upper section of the barrier body.

Simple fixture of the completely concealed photocells onto the specially designed seats on the barrier body.

More safety and reliability: obstacle detection and monitoring of motor absorption during automation movement.

Automatic fault diagnostics during operation with consequent signalling of fault type through specific flash sequences.

Provision for connection of latest generation optical and resistive sensitive edges (with 8.2 KOhm resistance).

Energy saving: the system sets to standby when not in use to save consumption.

No blackouts: emergency backup power with the optional batteries housed inside the case.

Release from side with metal key, can be installed on either side.

For bars up to 9 m, irreversible 230 Vac, 24 Vdc motor, with foundation plate:

Code	Description
LBAR	With steel case with protective cataphoresis treatment and paint finish
LBARI	With stainless steel case

Technical specifications

	LBAR	LBARI
Code		
Electrical data		
Power supply (Vac 50/60 Hz)	230	
Power supply (Vdc)	24	
Absorption (A)	1.3	
Power (W)	160	
Performance data		
Speed (s)	8 ÷ 12	
Torque (Nm)	400	
Work cycle (cycles/hour)	150	
Dimensional and general data		
Protection level (IP)	44	
Working temp. (°C Min/Max)	-20 ÷ +50	
Dimensions (mm)	500x299x1215 h	
Weight (kg)	98	

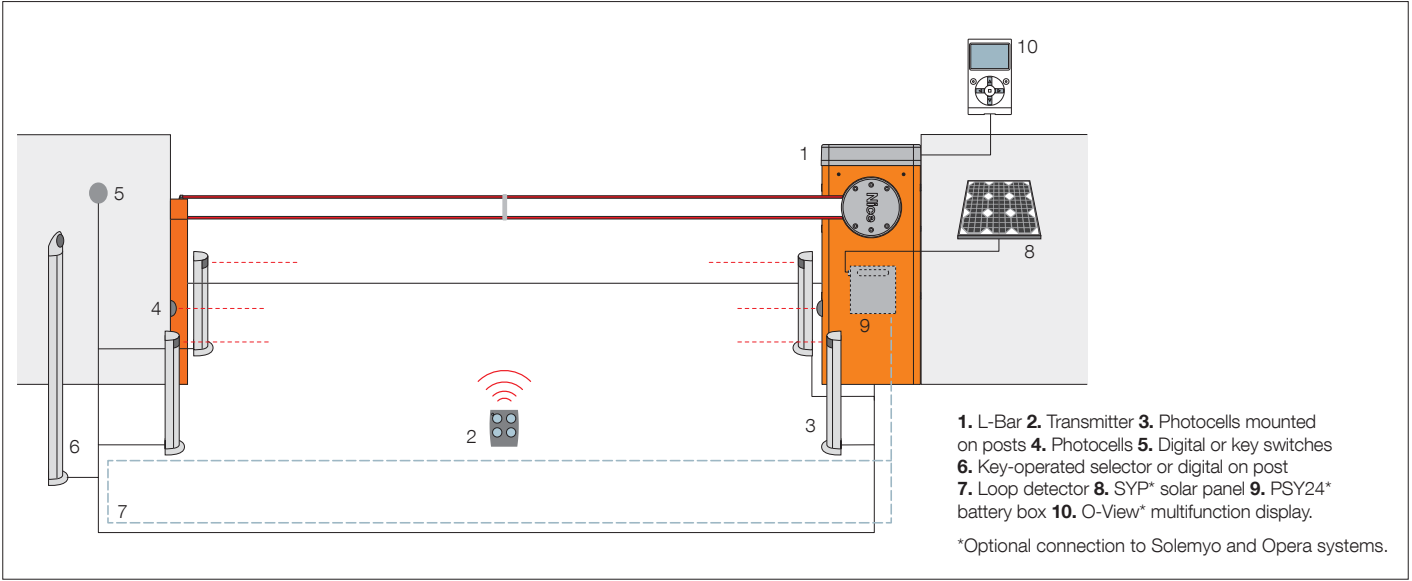

Accessories

Code	Description	Pc/pack
XBA3	Spare control unit	1
PS224	24 Vdc buffer battery	1
XBA15	White paint-finished aluminium bar 69x92x3150 mm	1
XBA14	White paint-finished aluminium bar 69x92x4150 mm	1
XBA5	White paint-finished aluminium bar 69x92x5150 mm	1
XBA9	Expansion joint	1
XBA13	Rubber impact protection strip. Length 1 m	9
WA10	Red adhesive reflector strips	24
XBA18	Indicator lights for click fixture on upper or lower side of bar. Length 8 m	1
XBA8	Integrable traffic light	1
XBA7	Integrable flashing light	1
WA13	Aluminium rack up to 2 m	1
XBA17	Anchorage base with clamps, for LBAR	1
WA12	Mobile stand for bars - <i>New fully reinforced version</i>	1
WA11	Adjustable stand for bars	1

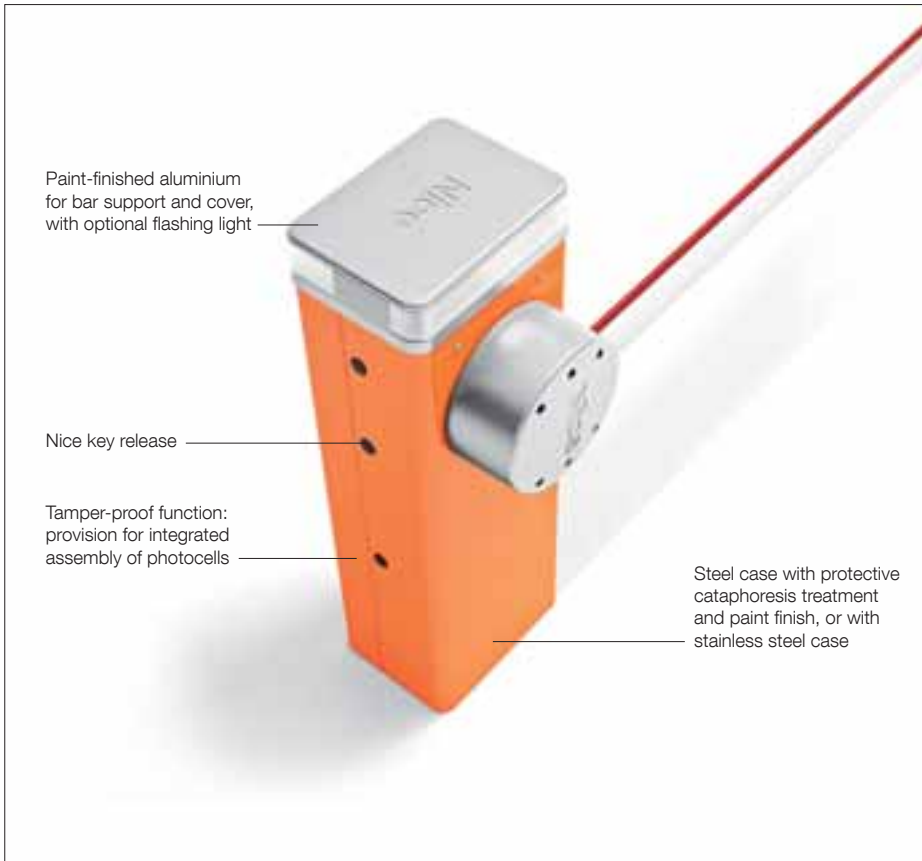

Electromechanical road barrier system for control of road access.
 24 Vdc gearmotor with built-in control unit and loop detector.
For bars up from 3 to 7 m.

Modular: are easily assembled using the aluminium expansion joint.

Possibility for intelligent control of two opposing automations thanks to **“master/slave” function.**

Strength and reliability: robust structure in steel, new high strength balancing springs guaranteed up to 1,000,000 opening and closing operations and elliptical section bar with high wind-gust resistance.

Optional flashing or traffic light can be integrated in cover.

Encoder movement control and electromechanical limit switches.

More comfort and safety in programming and maintenance phases: the separate enclosures for electronics and mechanics protect internal parts from potential risks.

Rapid and easy access to the control unit located in the upper section of the barrier body.

Simple fixture of the completely concealed photocells onto the specially designed seats on the barrier body.

More safety and reliability: obstacle detection and monitoring of motor absorption during automation movement.

Automatic fault diagnostics during operation with consequent signalling of fault type through specific flash sequences.

Provision for connection of latest generation optical and resistive sensitive edges (with 8.2 KOhm resistance).

Energy saving: the system sets to standby when not in use to save consumption.

No blackouts: emergency backup power with the optional batteries housed inside the case.

Release from side with metal key, can be installed on either side.

With bar up to 3 m, irreversible 230 Vac, 24 Vdc motor, with foundation plate:

Code	Description
M3BAR	With steel case with protective cataphoresis treatment and paint finish
M3BARI	With stainless steel case

With bar up to 4 or 5 m, irreversible 230 Vac, 24 Vdc motor, with foundation plate:

Code	Description
M5BAR	With steel case with protective cataphoresis treatment and paint finish
M5BARI	With stainless steel case

With bar up to 5, 6 or 7 m, irreversible 230 Vac, 24 Vdc motor, with foundation plate:

Code	Description
M7BAR	With steel case with protective cataphoresis treatment and paint finish
M7BARI	With stainless steel case

Technical specifications

Code	M3BAR	M3BARI	M5BAR	M5BARI	M7BAR	M7BARI
Electrical data						
Power supply (Vac 50/60 Hz)	230					
Power supply (Vdc)	24					
Absorption (A)	1.3		1.1		1.1	
Power (W)	150		110		110	
Performance data						
Speed (s)	1.5 ÷ 4		3 ÷ 6		6 ÷ 10	
Torque (Nm)	100		200		300	
Work cycle (cycles/hour)	500		350		200	
Dimensional and general data						
Protection level (IP)	44					
Working temp. (°C Min/Max)	-20 ÷ +50					
Dimensions (mm)	400x299x1215 h					
Peso (kg)	80			85		

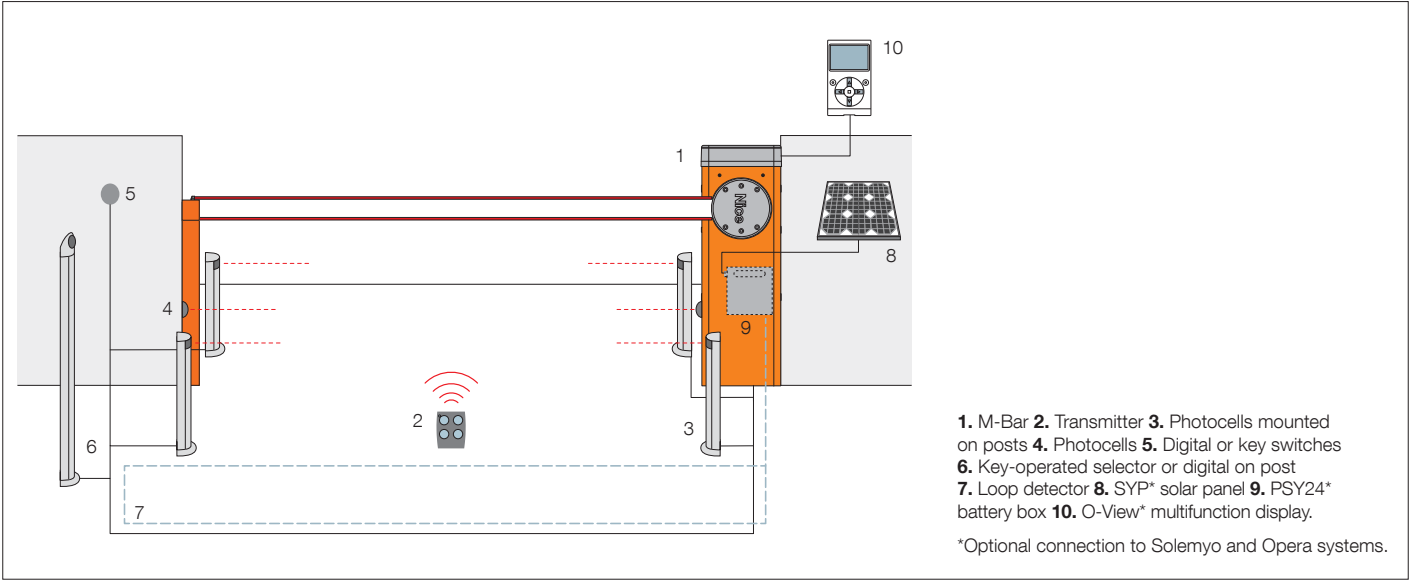

Accessories for M3BAR, M5BAR, M7BAR

Code	Description	Pc/pack
XBA3	Spare control unit	1
PS224	24 Vdc buffer battery	1
XBA13	Rubber impact protection strip. Length 1 m	9
WA10	Red adhesive reflector strips	24
XBA8	Integrable traffic light	1
XBA7	Integrable flashing light	1
XBA16	Anchorage base with clamps, for MBAR	1
WA11	Adjustable stand for bars	1

Accessories for M3BAR

Code	Description	Pc/pack
XBA15	White paint-finished aluminium bar 69x92x3150 mm	1
XBA4	Indicator lights for click fixture on upper or lower side of bar. Length 4 m	1
XBA10	Pivoting connection for bars up to 4 m	1
XBA11	Joint for bars XBA15	1

Accessories for M5BAR

Code	Description	Pc/pack
XBA14	White paint-finished aluminium bar 69x92x4150 mm	1
XBA5	White paint-finished aluminium bar 69x92x5150 mm	1
XBA4	Indicator lights for click fixture on upper or lower side of bar. Length 4 m	1
XBA6	Indicator lights for click fixture on upper or lower side of bar. Length 6 m	1
XBA10	Pivoting connection for bars up to 4 m	1
XBA11	Joint for bars XBA14	1
WA12	Mobile stand for bars - <i>New fully reinforced version</i>	1
WA13	Aluminium rack up to 2 m	1

Accessories for M7BAR

Code	Description	Pc/pack
XBA15	White paint-finished aluminium bar 69x92x3150 mm	1
XBA14	White paint-finished aluminium bar 69x92x4150 mm	1
XBA5	White paint-finished aluminium bar 69x92x5150 mm	1
XBA9	Expansion joint	1
XBA6	Indicator lights for click fixture on upper or lower side of bar. Length 6 m	1
XBA18	Indicator lights for click fixture on upper or lower side of bar. Length 8 m	1
WA12	Mobile stand for bars - <i>New fully reinforced version</i>	1
WA13	Aluminium rack up to 2 m	1

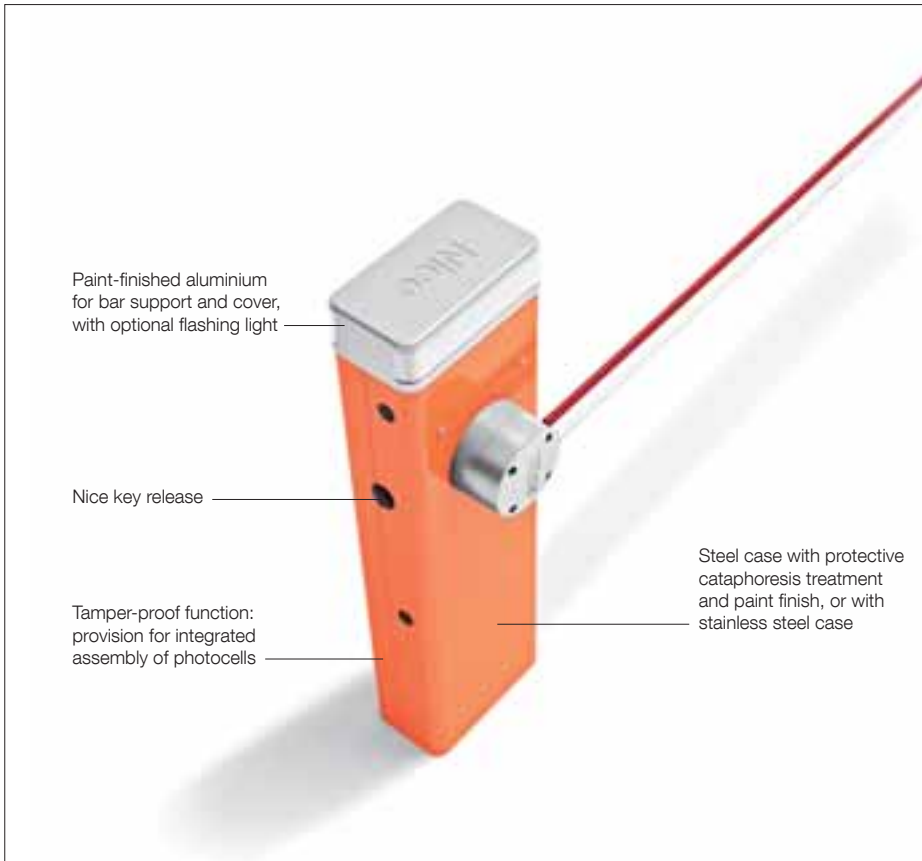

Electromechanical road barrier system for control of road access.

24 Vdc gearmotor with built-in control unit.

For bar up to 4 m.

Strength and reliability: robust structure in steel, new high strength balancing springs guaranteed up to 1,000,000 opening and closing operations and elliptical section bar with high wind-gust resistance.

Optional flashing or traffic light can be integrated in cover.

More comfort and safety in programming and maintenance phases: the separate enclosures for electronics and mechanics protect internal parts from potential risks.

Rapid and easy access to the control unit located in the upper section of the barrier body.

Simple fixture of the completely concealed photocells onto the specially designed seats on the barrier body.

More safety and reliability: obstacle detection and monitoring of motor absorptions during automation movement.

Automatic fault diagnostics during operation with consequent signalling of fault type through specific flash sequences.

Provision for connection of latest generation optical and resistive sensitive edges (with 8.2 KOhm resistance).

Energy saving: the system sets to standby when not in use to save consumption.

No blackouts: emergency backup power with the optional batteries housed inside the case.

Release from side with Nice triangular key, can be installed on either side.

With bar up to 4 m, irreversible 230 Vac, 24 Vdc motor, with foundation plate:

Code	Description
SBAR	With steel case with protective cataphoresis treatment and paint finish
SBARI	With stainless steel case

Technical specifications

	SBAR	SBARI
Electrical data		
Power supply (Vac 50/60 Hz)	230	
Power supply (Vdc)	24	
Absorption (A)	1	
Power (W)	300	
Performance data		
Speed (s)	<4	
Torque (Nm)	100	
Work cycle (cycles/hour)	100	
Dimensional and general data		
Protection level (IP)	44	
Working temp. (°C Min/Max)	-20 ÷ +50	
Dimensions (mm)	330x180x1180 h	
Peso (kg)	46	

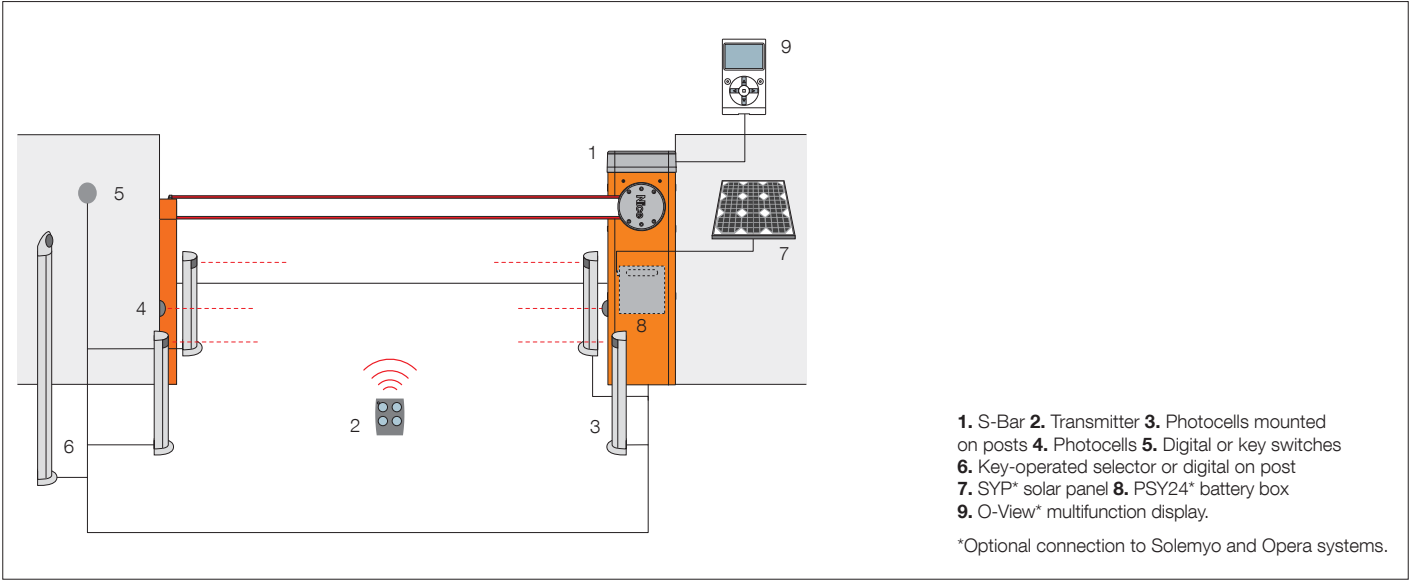

Accessories

Code	Description	Pc/pack
XBA20	Spare control unit for SBAR	1
PS124	24 V battery with integrated battery charger	1
XBA19	White paint-finished aluminium bar 45x58x4000 mm	1
XBA13	Rubber impact protection strip. Length 1 m	9
WA10	Red adhesive reflector strips	24
SIA1	Anchorage base with clamps	1
XBA7	Integrable flashing light	1
XBA4	Indicator lights for click fixture on upper or lower side of bar. Length 4 m	1
WA11	Adjustable stand for bars	1

Nice Opera Control, advanced management of automation systems also at a distance.

The innovative Opera system enables the installer to manage, program and control automation systems, also remotely, simply and safely, with significant savings in time.

Nice Opera simplifies the installer's work, making for easier programming, and enabling access to all control panel parameters to adapt the system to all requirements. No specific procedures needed for each product: single programming mode with intuitive menus, with no need to consult instructions.

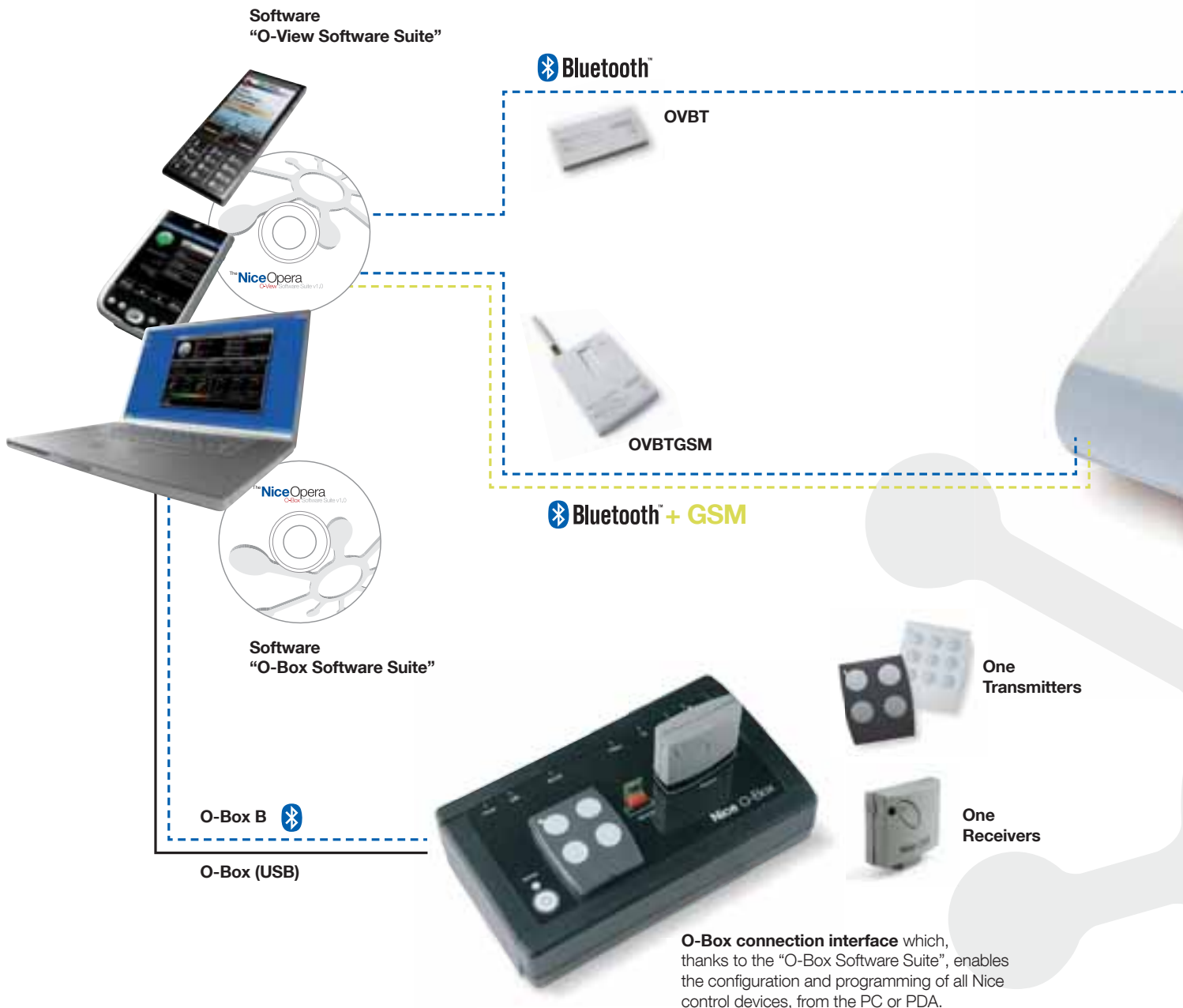

Constantly efficient assistance for all customers:

Simplifies system programming by means of the O-View multifunction display which when connected directly to the control panels compatible with the Opera system via BUS T4, enables full access to the system functions, for practical, rapid and advanced programming.

BUS T4 is the innovative communication protocol that enables you to create extensive networks of compatible automation systems, managing them from a single point via O-View.

Device management can be protected by two password levels. By interfacing the system with the PC, you can control a complex automation system such as those found in densely frequented buildings (hospitals, hotels, companies, etc.).



<<< BUS T4

O-View, multifunction display
Unit for control, programming and diagnostics for devices equipped with BUS T4 connection, on site or remotely via GPRS thanks to the connection with your PDA, Smartphone or PC.

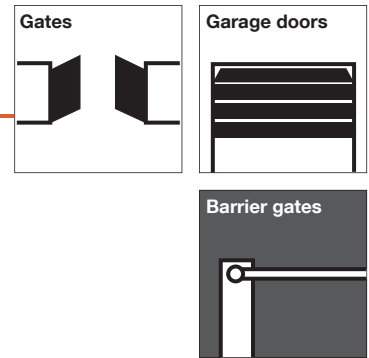

<<< BUS T4

OX4T universal 4-channel receiver with built-in transmitter. For remote control of any automation, irrigation and lighting systems or other electrical circuits.



Nice Motors not designed for

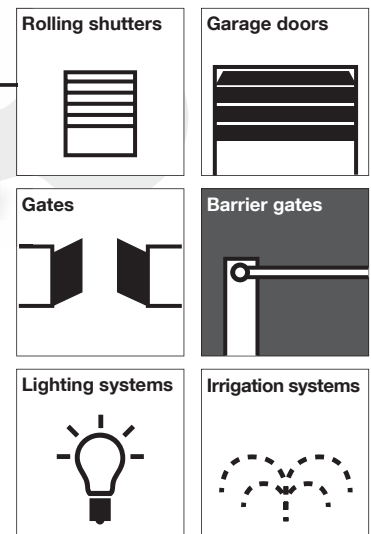

Opera



**Configurations
Compatibility
Connections**



Nice Systems for Season Ticket Holders Standard Terminal

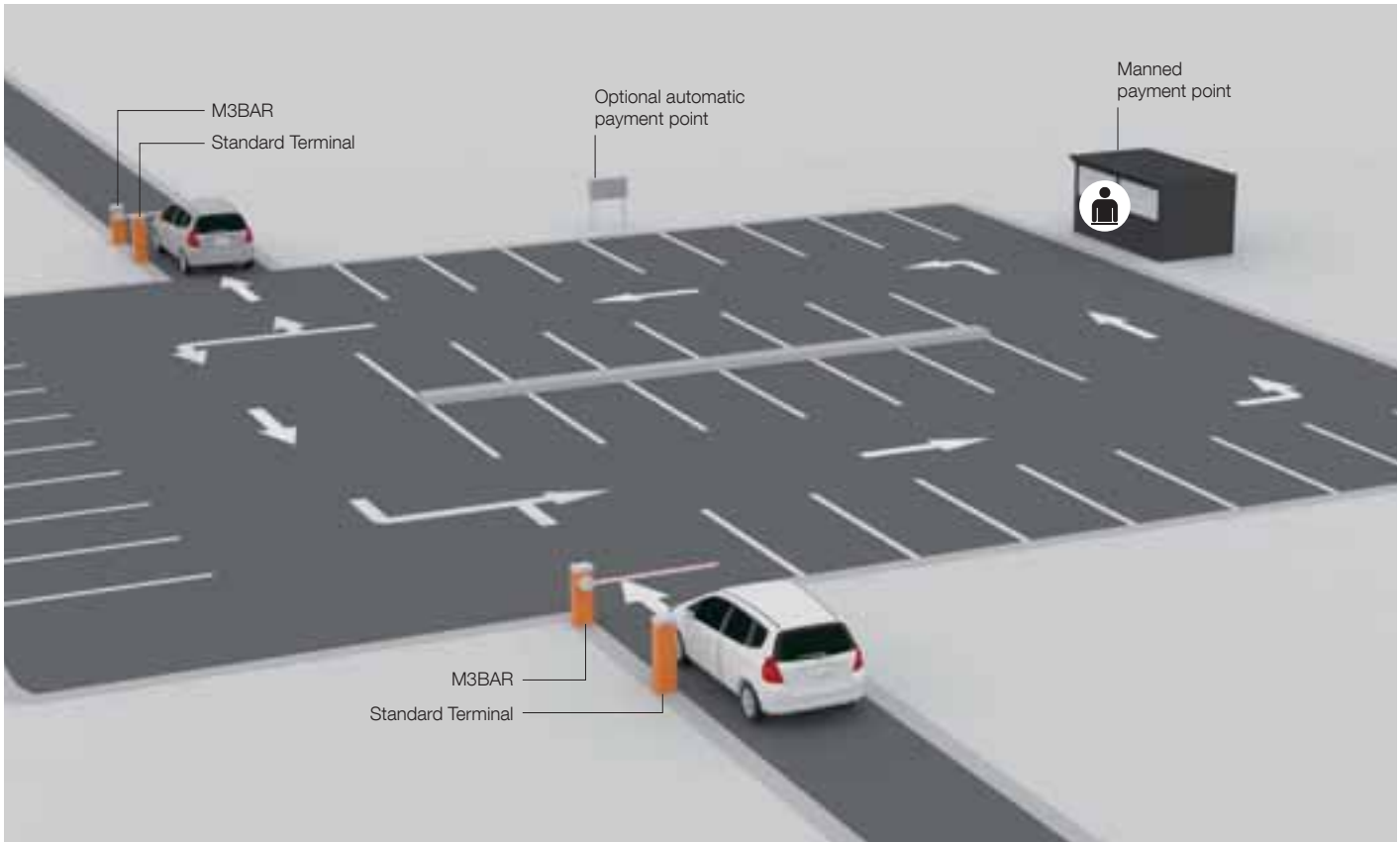

Code	Description	Q.ty	Opt.
Entrance Terminals			
PRKTSB	Basic Standard Terminal. Vehicle access control system for installation in both entrance and exit terminal configurations	1	
PRKATXMA1	Front panel for installation of RFID module only on basic terminals	1	
PRKATXRFIDRO	Basic hardware module for user recognition by means of Read Only RFID technology, 125 kHz	1	
Exit Terminals			
PRKTSB	Basic Standard Terminal. Vehicle access control system for installation in both entrance and exit terminal configurations	1	
PRKATXMA1	Front panel for installation of RFID module only on basic terminals	1	
PRKATXRFIDRO	Basic hardware module for user recognition by means of Read Only RFID technology, 125 kHz	1	
Server / Operator Station			
PRKSWDB	Database Server Software	1	
PRKCMPC	Personal Computer complete with operating system licence, LCD screen, keyboard and mouse and serial multiport for connection of field devices	1	
PRKATXRFIDRO	Basic hardware module for user recognition by means of desktop Read Only RFID technology, 125 KHz	1	
PRKSWCM	"Customer Manager" Software	1	
PRKACMSW	10/100 Mbit switch (at least 8 ports)	1	
Recommended road barrier systems			
M3BAR	Road barrier system with integral LED flashing light	2	
Consumables			
MOCARD	Pack of 10 RFID cards 125 KHz	1	•
PRKAPR	Thermal paper for ticket issuer	1	•

Nice Systems for Season Ticket Holders

Combi Terminal



Code	Description	Q.ty	Opt.
Entrance Terminals			
PRKTCB	Basic Combi Terminal. Vehicle access control system integrated with Nice road barrier system, ideal for installation in both input and output terminal configurations where access points are alongside each other	1	
PRKATXMA1	Front panel for installation of RFID module only on basic terminals	1	
PRKATXRFDRO	Basic hardware module for user recognition by means of Read Only RFID technology, 125 kHz	1	
Exit Terminals			
PRKTCB	Basic Combi Terminal. Vehicle access control system integrated with Nice road barrier system, ideal for installation in both input and output terminal configurations where access points are alongside each other	1	
PRKATXMA1	Front panel for installation of RFID module only on basic terminals	1	
PRKATXRFDRO	Basic hardware module for user recognition by means of Read Only RFID technology, 125 kHz	1	
Server / Operator Station			
PRKSWDB	Database Server Software	1	
PRKCMPC	Personal Computer complete with operating system licence, LCD screen, keyboard and mouse and serial multiport for connection of field devices	1	
PRKATXRFDRO	Basic hardware module for user recognition by means of desktop Read Only RFID technology, 125 KHz	1	
PRKSWCM	"Customer Manager" Software	1	
PRKACMSW	10/100 Mbit switch (at least 8 ports)	1	
Consumables			
MOCARD	Pack of 10 RFID cards 125 KHz	1	•
PRKAPR	Thermal paper for ticket issuer	1	•

Nice Systems for Season Ticket Holders

Number plate recognition

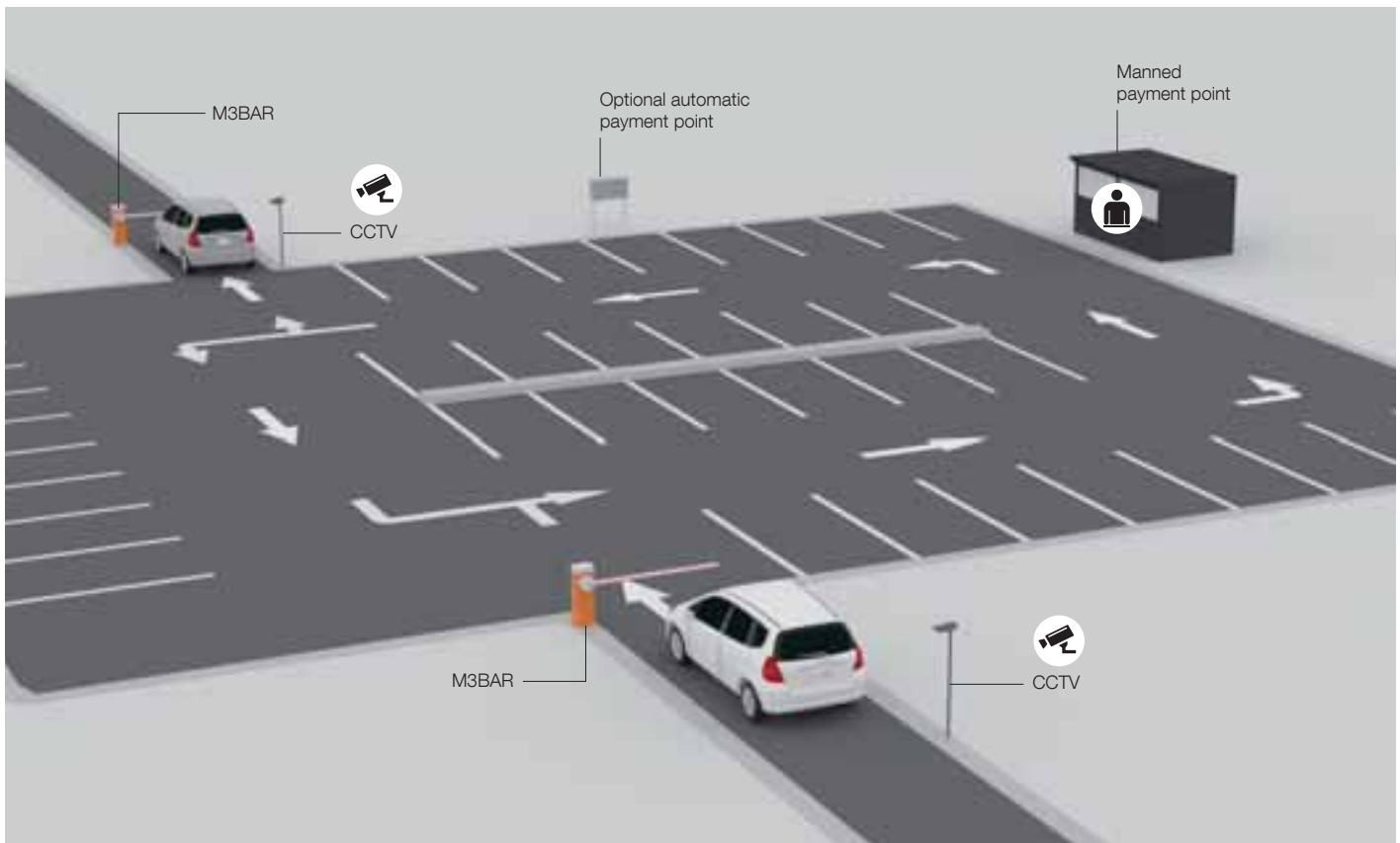

Code	Description	Q.ty	Opt.
Entrance Terminals			
PRKATXLPR	Basic hardware module for user recognition by means of number plate recognition system	1	
Exit Terminals			
PRKATXLPR	Basic hardware module for user recognition by means of number plate recognition system	1	
Server / Operator Station			
PRKSWDB	Database Server Software	1	
PRKCMPC	Personal Computer complete with operating system licence, LCD screen, keyboard and mouse and serial multiport for connection of field devices	1	
PRKSWCM	"Customer Manager" Software	1	
PRKSWTM	Additional Client Software for management of Access Control Logic	2	
Recommended road barrier systems			
M3BAR	Road barrier system with integral LED flashing light	2	

Nice Systems for Season Ticket Holders

Optional equipment

Code	Description	Q.ty	Opt.
Entrance Terminal Options			
PRKAXTLL	LED traffic light	1	•
PRKAICM	Two-way outdoor intercom	1	•
PRKSWCADV	Client Software for management of "Advertising Scheduler"	1	•
Exit Terminal Options			
PRKAXTLL	LED traffic light	1	•
PRKAICM	Two-way outdoor intercom	1	•
PRKSWCADV	Client Software for management of "Advertising Scheduler"	1	•
Server / Operator Station Options			
PRKSWMC	"Manual Cash" Software	1	•
PRKSWSM	"System Monitor" Software	1	•
PRKACMPRN	Basic hardware model for issuing non-fiscal receipt and/or ticket with barcode by means of desktop thermal printer	1	•
PRKADISP	Courtesy display for customers	1	•
PRKADRA	Metal cash box with security key	1	•
PRKSWCADV	Client Software for management of "Advertising Scheduler"	1	•
Automatic Payment Point			
PRKCAB	Automatic Payment Point equipped with coin and banknote acceptor system, Read Only two-dimensional barcode and RFID card reader, LCD information display, and thermostatically controlled tamper-proof structure	1	•
Automatic Payment Point Options			
PRKACACCR	Credit/debit card reader	1	•
PRKSWCADV	Client Software for management of "Advertising Scheduler"	1	•
PRKAICM	Two-way outdoor intercom	1	•
PRKACASFF	Ground anchoring system	1	•
Accessories			
PRKAXXBP	Information screen with 1 three-figure vacancy counter and full/vacancies sign	1	•
PRKAXXBPRK	Numerical programming keyboard for information screen	1	•

Nice Systems for Occasional Users and Season Ticket Holders Standard Terminal



Code	Description	Q.ty	Opt.
Entrance Terminals			
PRKTSB001	Basic Standard Terminal (PRKTSB). Complete with: - PRKATXRFIDRO Basic hardware module for user recognition by means of Read Only RFID technology, 125 kHz - PRKATXPRN Basic hardware model for issuing barcode tickets to users by means of thermal printer - PRKATXMA2 Front panel for installation of additional printer module on basic terminals	1	
Exit Terminals			
PRKTSB002	Basic Standard Terminal (PRKTSB). Complete with: - PRKATXRFIDRO Basic hardware module for user recognition by means of Read Only RFID technology, 125 kHz - PRKATXIMG Basic hardware module for user recognition by means of barcode reader - PRKATXMA3 Front panel for installation of additional optical reader module on basic terminals	1	
Server / Operator Station			
PRKCMKIT	Manned Manual Payment Point Kit for car-park payment management	1	
Recommended road barrier systems			
M3BAR	Road barrier system with integral LED flashing light	2	
Consumables			
MOCARD	Pack of 10 RFID cards 125 KHz	1	•
PRKAPR	Thermal paper for ticket issuer	1	•

Nice Systems for Occasional Users and Season Ticket Holders Combi Terminal



Code	Description	Q.ty	Opt.
Entrance Terminals			
PRKTCB001	Basic Combi Terminal (PRKTCB). Complete with: - PRKATXRFIDRO Basic hardware module for user recognition by means of Read Only RFID technology, 125 kHz - PRKATXPRN Basic hardware model for issuing barcode tickets to users by means of thermal printer - PRKATXMA2 Front panel for installation of additional printer module on basic terminals	1	
Exit Terminals			
PRKTCB002	Basic Combi Terminal (PRKTCB). Complete with: - PRKATXRFIDRO Basic hardware module for user recognition by means of Read Only RFID technology, 125 kHz - PRKATXIMG Basic hardware module for user recognition by means of barcode reader - PRKATXMA3 Front panel for installation of additional optical reader module on basic terminals		
Server / Operator Station			
PRKCMKIT	Manned Manual Payment Point Kit for car-park payment management	1	
Consumables			
MOCARD	Pack of 10 RFID cards 125 KHz	1	•
PRKAPR	Thermal paper for ticket issuer	1	•

Nice Systems for Occasional Users and Season Ticket Holders

Number plate recognition

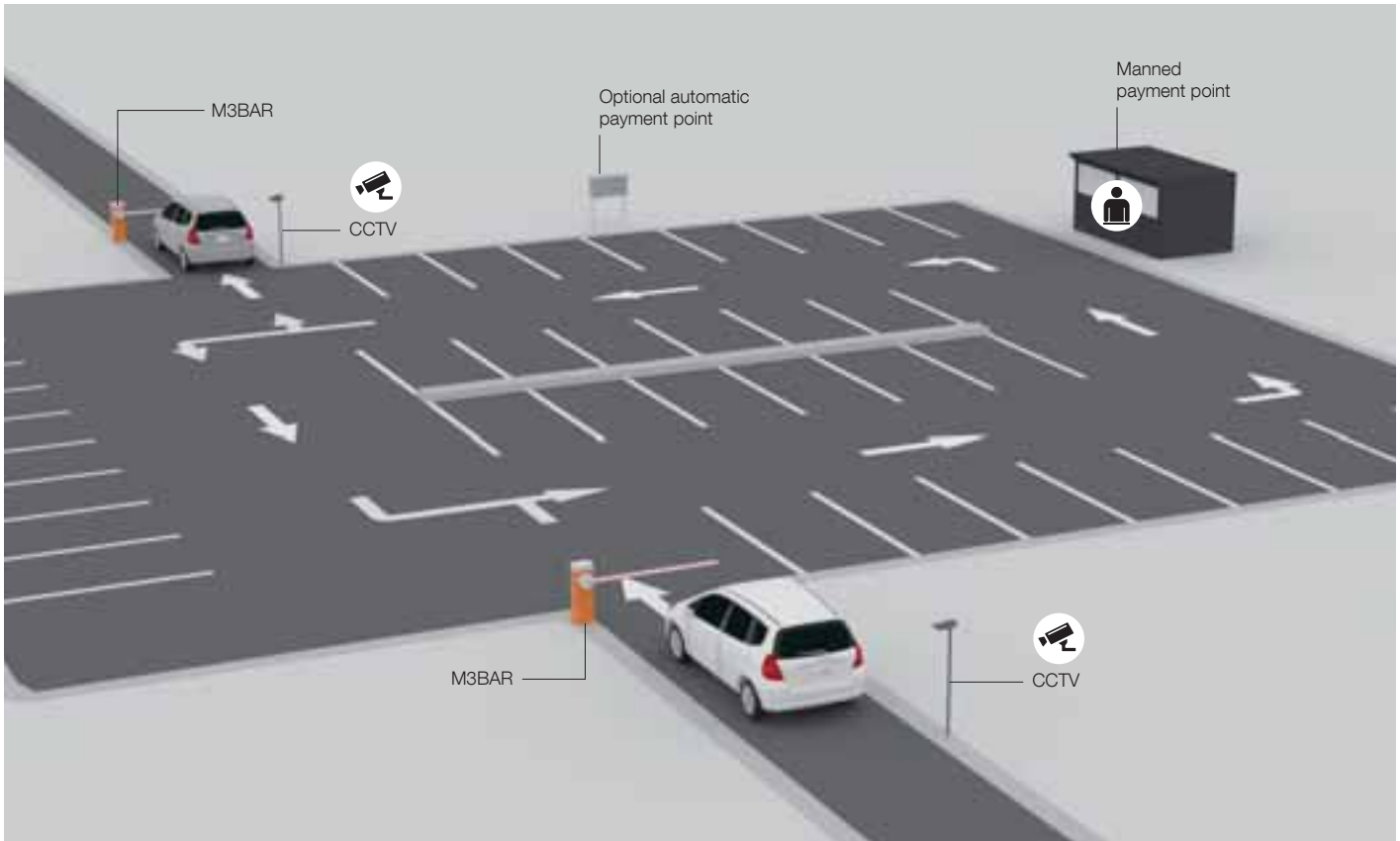

Code	Description	Q.ty	Opt.
Entrance Terminals			
PRKATXLPR	Basic hardware module for user recognition by means of number plate recognition system	1	
Exit Terminals			
PRKATXLPR	Basic hardware module for user recognition by means of number plate recognition system	1	
Server / Operator Station			
PRKSWDB	Database Server Software	1	
PRKCMPC	Personal Computer complete with operating system licence, LCD screen, keyboard and mouse and serial multiport for connection of field devices	1	
PRKACMPRN	Basic hardware model for issuing non-fiscal receipt and/or ticket with barcode by means of desktop thermal printer (essential if the "Manual Cash" module is used for payments)	1	
PRKSWCM	"Customer Manager" Software	1	
PRKSWMC	"Manual Cash" Software	1	
PRKSWTM	Additional Client Software for management of Access Control Logic	2	
Recommended road barrier systems			
M3BAR	Road barrier system with integral LED flashing light	2	
Consumables			
PRKAPR	Thermal paper for ticket issuer	1	•

Nice Systems for Occasional Users and Season Ticket Holders

Optional equipment

Code	Description	Q.ty	Opt.
Entrance Terminal Options			
PRKAXTLL	LED traffic light	1	•
PRKAICM	Two-way outdoor intercom	1	•
PRKSWCADV	Client Software for management of "Advertising Scheduler"	1	•
Exit Terminal Options			
PRKAXTLL	LED traffic light	1	•
PRKAICM	Two-way outdoor intercom	1	•
PRKSWCADV	Client Software for management of "Advertising Scheduler"	1	•
Server / Operator Station Options			
PRKSWSM	"System Monitor" Software	1	•
PRKSWCADV	Client Software for management of "Advertising Scheduler"	1	•
PRKAICM	Two-way outdoor intercom	1	•
Automatic Payment Point			
PRKCAB	Automatic Payment Point equipped with coin and banknote acceptor system, Read Only two-dimensional barcode and RFID card reader, LCD information display, and thermostatically controlled tamper-proof structure	1	•
Automatic Payment Point Options			
PRKACCCR	Credit/debit card reader	1	•
PRKSWCADV	Client Software for management of "Advertising Scheduler"	1	•
PRKAICM	Two-way outdoor intercom	1	•
PRKACASFF	Ground anchoring system	1	•
Accessories			
PRKAXXBP	Information screen with 1 three-figure vacancy counter and full/vacancies sign	1	•
PRKAXXBPBK	Numerical programming keyboard for information screen	1	•

Nice Off-Line Systems Standard Terminal



Code	Description	Q.ty	Opt.
Exit Terminals			
PRKTSB002	Basic Standard Terminal (PRKTSB). Complete with: - PRKATXRFIDRO Basic hardware module for user recognition by means of Read Only RFID technology, 125 kHz - PRKATXIMG Basic hardware module for user recognition by means of barcode reader - PRKATXMA3 Front panel for installation of additional optical reader module on basic terminals	1	
Server / Operator Station			
PRKCMKIT	Manned Manual Payment Point Kit for car-park payment management	1	
Recommended road barrier systems			
M3BAR	Road barrier system with integral LED flashing light	2	
Accessories			
PRKAXXBP	Information screen with 1 three-figure vacancy counter and full/vacancies sign	1	
PRKAXXBPRK	Numerical programming keyboard for information screen	1	
Consumables			
MOCARD	Pack of 10 RFID cards 125 KHz	1	•
PRKAPR	Thermal paper for ticket issuer	1	•

Nice Off-Line Systems Combi Terminal

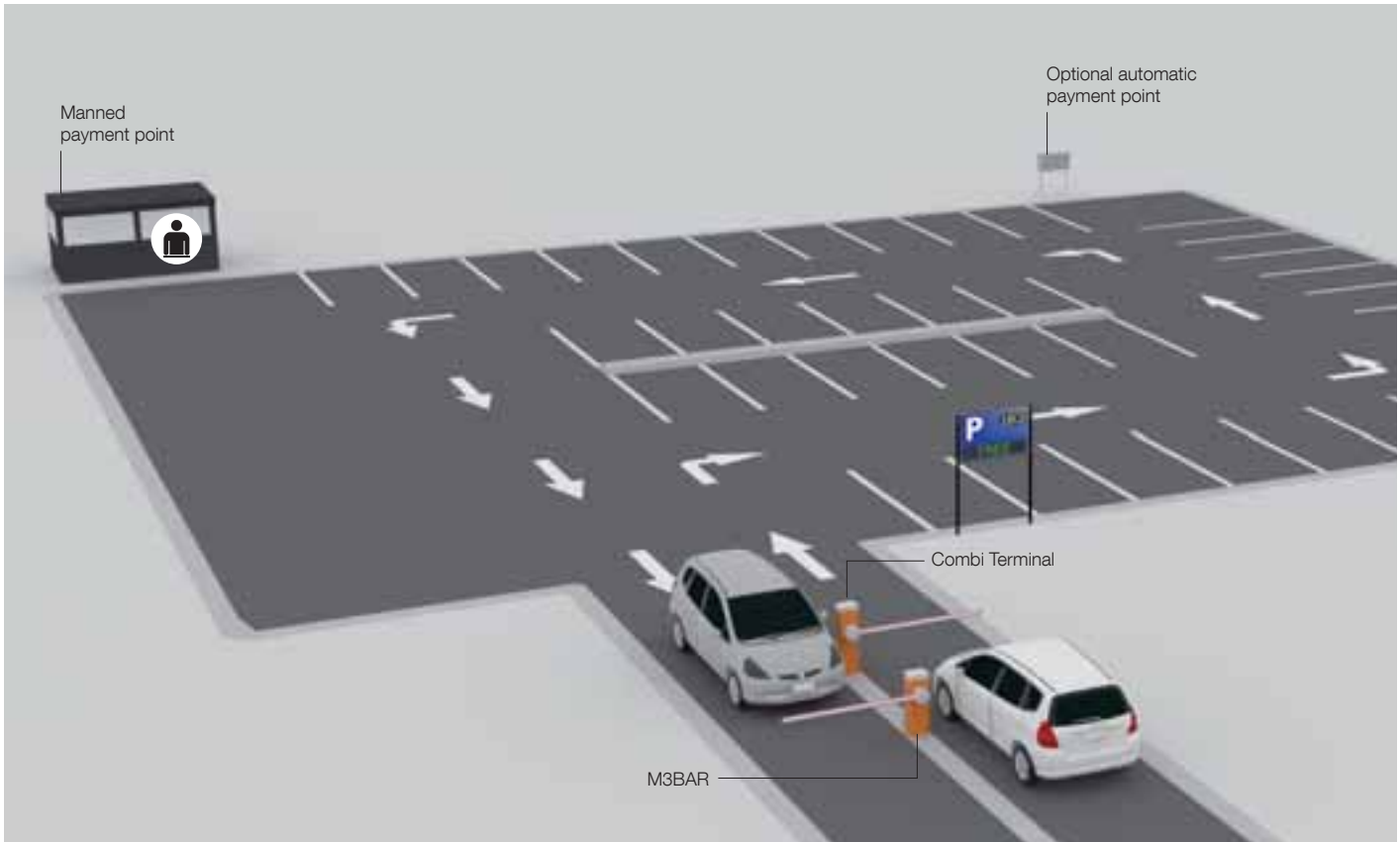

Code	Description	Q.ty	Opt.
Exit Terminals			
PRKTCB002	Basic Combi Terminal (PRKTCB). Complete with: - PRKATXRFIDRO Basic hardware module for user recognition by means of Read Only RFID technology, 125 kHz - PRKATXIMG Basic hardware module for user recognition by means of barcode reader - PRKATXMA3 Front panel for installation of additional optical reader module on basic terminals		
Server / Operator Station			
PRKCMKIT	Manned Manual Payment Point Kit for car-park payment management	1	
Recommended road barrier systems			
M3BAR	Road barrier system with integral LED flashing light	1	
Accessories			
PRKAXXBP	Information screen with 1 three-figure vacancy counter and full/vacancies sign	1	
PRKAXXBPRK	Numerical programming keyboard for information screen	1	
Consumables			
MOCARD	Pack of 10 RFID cards 125 KHz	1	•
PRKAPR	Thermal paper for ticket issuer	1	•

Nice Off-Line Systems

Number plate recognition

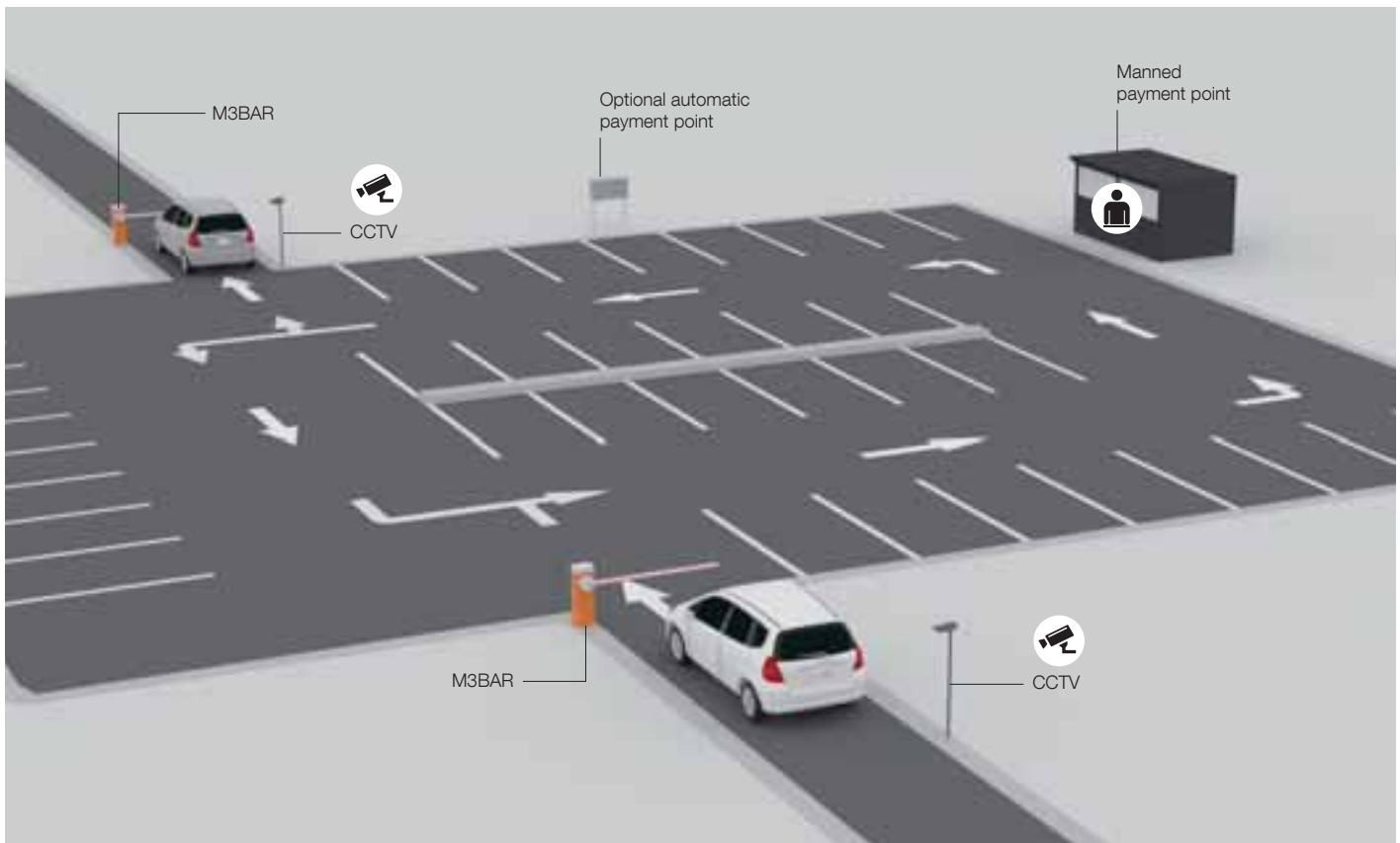

Code	Description	Q.ty	Opt.
Entrance Terminals			
PRKATXLPR	Basic hardware module for user recognition by means of number plate recognition system	1	
Exit Terminals			
PRKATXLPR	Basic hardware module for user recognition by means of number plate recognition system	1	
Server / Operator Station			
PRKSWDB	Database Server Software	1	
PRKCMPC	Personal Computer complete with operating system licence, LCD screen, keyboard and mouse and serial multiport for connection of field devices	1	
PRKACMPRN	Basic hardware model for issuing non-fiscal receipt and/or ticket with barcode by means of desktop thermal printer	1	
PRKSWCM	"Customer Manager" Software	1	
PRKSWMC	"Manual Cash" Software	1	
PRKSWTM	Additional Client Software for management of Access Control Logic	2	
Recommended road barrier systems			
M3BAR	Road barrier system with integral LED flashing light	2	
Consumables			
PRKAPR	Thermal paper for ticket issuer	1	•

Nice Off-Line Systems

Optional equipment

Code	Description	Q.ty	Opt.
Exit Terminal Options			
PRKAXTLL	LED traffic light	1	•
PRKAICM	Two-way outdoor intercom	1	•
PRKSWCADV	Client Software for management of "Advertising Scheduler"	1	•
Server / Operator Station Options			
PRKSWSM	"System Monitor" Software	1	•
PRKSWCADV	Client Software for management of "Advertising Scheduler"	1	•
PRKAICM	Two-way outdoor intercom	1	•
Automatic Payment Point			
PRKACAB	Automatic Payment Point equipped with coin and banknote acceptor system, Read Only two-dimensional barcode and RFID card reader, LCD information display, and thermostatically controlled tamper-proof structure	1	•
Automatic Payment Point Options			
PRKACACCR	Credit/debit card reader	1	•
PRKSWCADV	Client Software for management of "Advertising Scheduler"	1	•
PRKAICM	Two-way outdoor intercom	1	•
PRKACASFF	Ground anchoring system	1	•

Nice Standard Terminal Connections



Nice Combi Terminal Connections



Nice Server / Manual Cash Connections

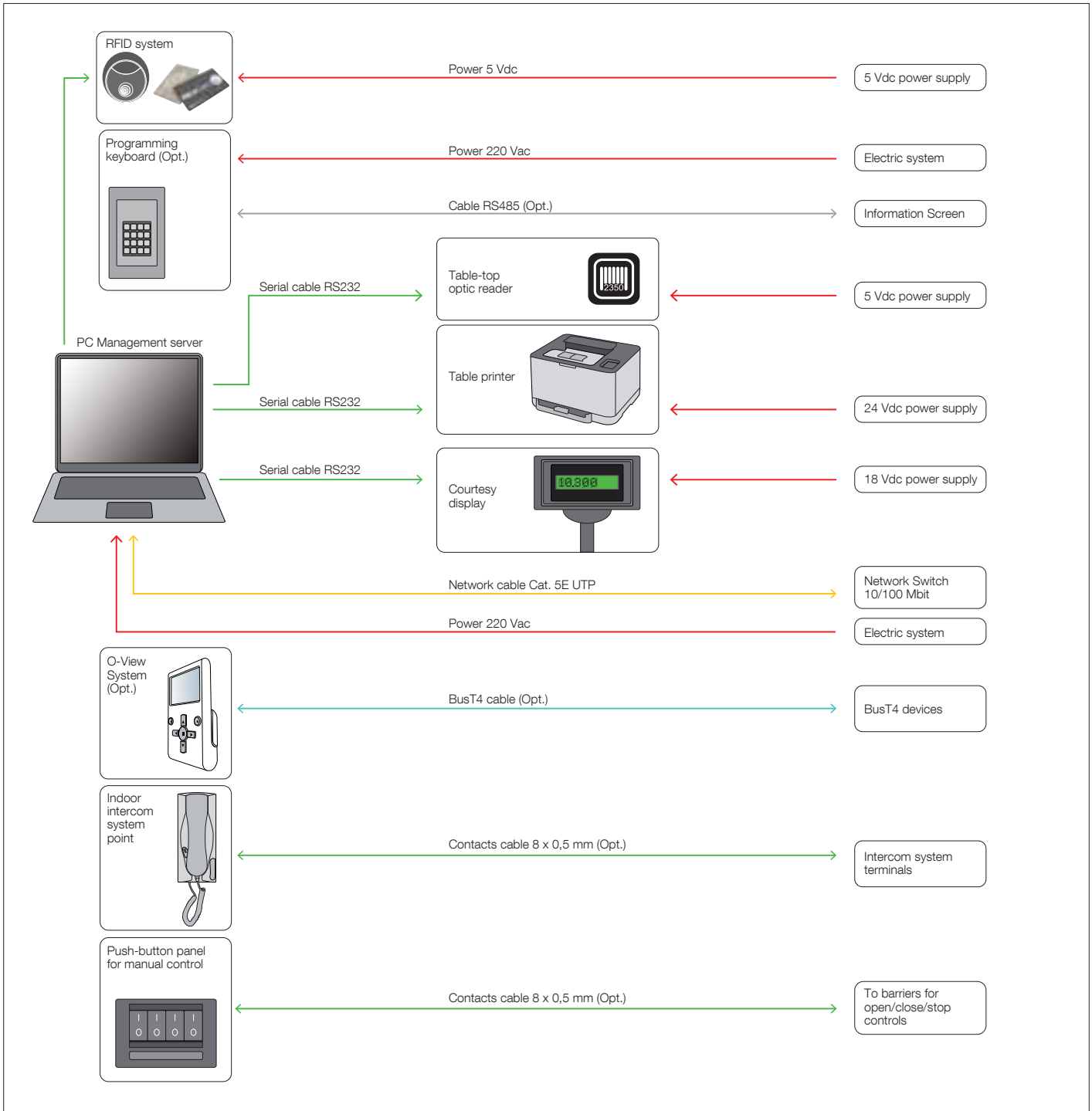

Nice Compatibility

Code	Description	Standard Terminal	Combi Terminal	Server	Customer Management	Automatic Cash	Supervisor	Configurator
PRKTSB	Basic Standard Terminal. Vehicle access control system for installation in both entrance and exit terminal configurations	•						
PRKTSB001	Basic Standard Terminal (PRKTSB). Complete with: PRKATXRFIDRO, PRKATXPRN, PRKATXMA2	•						
PRKTSB002	Basic Standard Terminal (PRKTSB). Complete with: PRKATXRFIDRO, PRKATXIMG, PRKATXMA3	•						
PRKTCB	Basic Combi Terminal. Vehicle access control system integrated with Nice road barrier system, ideal for installation in both input and output terminal configurations where access points are alongside each other		•					
PRKTCB001	Basic Combi Terminal (PRKTCB). Complete with: PRKATXRFIDRO, PRKATXPRN, PRKATXMA2		•					
PRKTCB002	Basic Combi Terminal (PRKTCB). Complete with: PRKATXRFIDRO, PRKATXIMG, PRKATXMA3		•					
PRKACMPRN	Basic hardware model for issuing barcode tickets to users by means of thermal printer	•	•					
PRKATXIMG	Basic hardware module for user recognition by means of barcode reader	•	•		•			
PRKATXRFIDRW	Basic hardware module for user recognition by means of MiFare Read & Write RFID technology, 13.56 Mhz	•	•		•			
PRKATXLPR	Basic hardware module for user recognition by means of number plate recognition system	•	•					
PRKATXMA1	Front panel for installation of RFID module only on basic terminals	•	•					
PRKATXMA2	Front panel for installation of additional printer module on basic terminals (PRKTSB)	•	•					
PRKATXMA3	Front panel for installation of additional optical reader module on basic terminals (PRKTSB)	•	•					
PRKATXMA4	Front panel for installation of additional printer and optical reader module on basic terminals (PRKTSB)	•	•					
PRKSWTM	Additional Client Software for management of Access Control Logic	•	•					
PRKSWCADV	Client Software for management of "Advertising Scheduler"	•	•		•	•		
PRKAXTLL	LED traffic light	•	•					
PRKAXBP	Information screen with 1 three-figure vacancy counter and full/vacancies sign	•	•					
LP1	Single-channel metal mass detector 24 V power supply	•	•					
LP2	Two-channel metal mass detector 24 V power supply	•	•					
PRKAICM	Two-way outdoor intercom	•	•			•		
PRKAPR	Thermal paper for ticket issuer	•	•			•		
MOCARD	Pack of 10 RFID cards 125 KHz	•	•		•	•		
MIFCARD	Pack of 10 MiFare Read & Write RFID cards	•	•		•	•		
PRKSWDB	Database Server Software			•				
PRKCMPC	Personal Computer complete with operating system licence, LCD screen, keyboard and mouse and serial multiport for connection of field devices				•	•	•	•
PRKSWMC	"Manual Cash" Software				•			
PRKSWCM	"Customer Manager" Software				•			
PRKSWSM	"System Monitor" Software				•			
PRKACMIMG	Basic hardware module for user recognition by means of desktop barcode reader				•			
PRKACMRIDRO	Basic hardware module for user recognition by means of desktop Read Only RFID technology, 125 KHz				•			
PRKACMRIDRW	Basic hardware module for user recognition by means of desktop MiFare Read & Write RFID technology, 13.56 Mhz				•			
PRKCAB	Automatic Payment Point equipped with coin and banknote acceptor system, Read Only two-dimensional barcode and RFID card reader, LCD information display, and thermostatically controlled tamper-proof structure					•		
PRKACACCR	Credit/debit card reader					•		
PRKSWSV	Supervision software system for car parks and access control systems in general						•	
PRKSWCF	Configuration software system for car parks and access control systems in general							•
PRKACMSW	10/100 Mbit switch (at least 8 ports)	•	•	•	•	•	•	•
PRKADISP	Courtesy display for customers				•			
PRKADRA	Metal cash box with security key				•			
PRKATXPRN	Basic hardware model for issuing barcode tickets to users by means of thermal printer	•	•					
PRKATXRFIDRO	Basic hardware module for user recognition by means of desktop Read Only RFID technology, 125 KHz	•	•					
PRKAXBPRK	Numerical programming keyboard for information screen				•			
PRKCMKIT	Manned Manual Payment Point Kit for car-park payment management				•	•		
PRKSWAE	Advertising Editor Software				•	•		

Nice

Product Design
Roberto Gherlenda

Nice SpA

Oderzo TV Italia
Ph. +39.0422.85.38.38
Fax +39.0422.85.35.85
info@niceforyou.com

Find out more about Nice
products and services on the website:
www.niceforyou.com



Home Automation